

Appendices

Appendix A:	Historic, Geologic and Scenic Sites
Appendix B:	Natural Resources (Mackinac Island State Parks Checklists)
Appendix C:	Mackinac Island Airport Layout Plan
Appendix D:	Stakeholder Interviews Results
Appendix E:	Student Survey Results
Appendix F:	Community Workshop Results

Appendix A

Historic, Geologic and Scenic Sites

- National and State Register Historic Sites
- Selected Geologic and Scenic Sites

**NATIONAL AND STATE REGISTER HISTORIC SITES
AS OF MARCH, 2010**

(Note: Number in parenthesis is a reference to site file information kept
at the State Historic Preservation Office, Michigan Historical Center,
Michigan Department of State, Lansing Michigan)

1. **Agency House of the American Fur Company Stuart, Robert, House** (P23995)
Market Street, Mackinac Island
National Register listed 04/16/1971
State Register listed 03/23/1965
2. **American Fur Company Retail Store** (P23996)
Market Street, Mackinac Island
State Register listed 06/10/1980
3. **Battlefield of 1814** (P23997)
Near Wawashkamo Golf Club, on British Landing Road, Mackinac Island
State Register listed 03/19/1958
Marker Erected 06/06/1958
4. **Beaumont's Medical Discovery/ Beaumont Memorial** (P23998)
Market Street at Fort Street, Mackinac Island
State Register listed 02/18/1956
Marker Erected 05/10/1982
5. **Biddle House** (P23999)
Market Street, Mackinac Island
State Register listed 07/19/1956
Marker Erected 05/13/1960
6. **British Cannon Site** (P24000)
Rear of Fort Mackinac Island, high ground north of the fort, Mackinac Island
State Register listed 02/12/1959
Marker Erected 06/01/1959
7. **British Landing** (P24001)
Northwest shore of Mackinac Island, Mackinac Island
State Register listed 03/19/1958
Marker Erected 06/06/1958
8. **Cudahy Residence/ Williams, G. Mennen, Summer Home** (P24002)
West Bluff, Mackinac Island
State Register listed 01/19/1978
9. **Davenport, Ambrose R., House** (P24004)
North Street, Hubbard's Annex, Mackinac Island
State Register listed 06/30/1988

NATIONAL AND STATE REGISTER HISTORIC SITES CONTINUED

10. **Davis-Preston House/ Haan, Joyce and Vernon, House** (P24005)
Huron Street, east of Saint Anne's Catholic Church, Mackinac Island
State Register listed 05/17/1978
11. **Early French Missionary Chapel** (P24006)
Fort Street, north of Main, near sidewalk to fort, Mackinac Island
State Register listed 05/01/1959
Marker Erected 05/27/1959
12. **Fort Holmes** (P24007)
Fort Holmes Road, north of the business district, Mackinac Island
State Register listed 09/25/1956
Marker Erected 05/29/1959
13. **Fort Mackinac** (P24008)
Huron Road, Mackinac Island
National Register listed 07/08/1970
State Register listed 02/19/1958
Marker Erected 06/06/1958
14. **Geary, Mathew, House** (P24009)
Market Street, Mackinac Island
National Register listed 05/06/1971
State Register listed 02/11/1970
15. **Grand Hotel** (P188)
Grand Hotel Avenue, Mackinac Island
National Historic Landmark listed 06/29/1989
State Register listed 07/12/1957
National Register listed 05/05/1972
Marker Erected 1958
16. **Indian Dormitory** (P24012)
Huron Street, next to Marquette Park, Mackinac Island
National Register listed 11/05/1971
State Register listed 02/17/1965
Marker Erected 04/27/1966
17. **Island House** (P24013)
Huron Street, Mackinac Island
State Register listed 03/14/1973
Marker Erected 06/06/1973

NATIONAL AND STATE REGISTER HISTORIC SITES CONTINUED

18. Lake View House/ Lake View Hotel (P24014)

SW end of Huron Street, Mackinac Island

State Register listed 01/13/1982

Marker Erected 08/14/1985

Note: As of August 2010, this site was planned for delisting, but the process was not officially started.

19. Mackinac Conference Informational Site/Grand Hotel (P24015)

Grounds of the Grand Hotel, Mackinac Island

State Register listed 08/15/1975

Marker Erected 08/28/1975

20. Mackinac Island (P200)

Mackinac Island

National Historic Landmark listed 10/09/1960

National Register listed 10/15/1966

State Register listed 07/19/1956

Marker Erected 12/07/1956

21. Market Street (P24017)

Market Street, Mackinac Island

State Register listed 07/19/1956

Marker Erected 11/09/1956

22. Mission Church (P24018)

Huron Street, corner of Truscott Street, Mackinac Island

National Register listed 01/25/1971

State Register listed 07/19/1956

Marker Erected 04/12/1957

23. Mission House (P24019)

East end of Huron Street, Mackinac Island

National Register listed 04/16/1971

State Register listed 11/06/1970

Marker Erected 07/27/1993

24. Round Island Lighthouse Informational Designation (P24020)

Foot of Huron Street, next to the Iroquois Hotel, in the municipal park overlooking the Round Island Lighthouse, Mackinac Island

National Register listed 08/21/1974

State Register listed 04/23/1971

Marker Erected 05/18/1978

25. Sainte Anne de Michilimackinac Roman Catholic Church/ Sainte Anne's Church (P24021)

Huron Street at the corner of Church Street, Mackinac Island

State Register listed 12/20/1990

Marker Erected 03/03/1992

NATIONAL AND STATE REGISTER HISTORIC SITES CONTINUED

26. Silver Birches (P24022)

On M-185, NE part of the island, Mackinac Island
State Register listed 09/08/1982

27. Skull Cave (P24023)

Garrison Road, Mackinac Island
State Register listed 01/12/1959
Marker Erected 05/04/1959

28. Stuart, Robert, Office Building/ Mackinac Island Town Crier Building (P24024)

34 Market Street, Mackinac Island
State Register listed 06/23/1983

29. Trinity Episcopal Church (P24025)

Fort Street, Mackinac Island
State Register listed 07/11/1968
Marker Erected 08/26/1968

30. Union Congregational Church/ Little Stone Church (P24026)

Cadotte Street, Mackinac Island
State Register listed 03/28/1979
Marker Erected 06/26/1979

31. Wawashkamo Golf Club (P24027)

British Landing Road, Mackinac Island
State Register listed 09/08/1982
Marker Erected 04/28/1983

32. Young, Lawrence Andrew, Cottage/ Governor's Summer Residence (P24010)

Huron Road, Mackinac Island
State Register listed 10/21/1975
National Register listed 11/17/1997

SELECTED GEOLOGIC & SCENIC SITES

- A. Arch Rock
- B. Sugar Loaf
- C. Robinson's Folly
- D. Lover's Leap
- E. Sunset Rock
- F. Altar Rock; Tabernacle Rock; Friendship's Altar (alternate names)
- G. Anne's Tablet
- H. Father Marquette Statue
- I. British Landing Trail
- J. Wildflower Walk Trail
- K. Devil's Kitchen
- L. Brown's Brook
- M. Dwightwood Spring
- N. Point Lookout (overlooking Sugar Loaf)
- O. Crack in the Island
- P. Pontiac's Lookout
- Q. Nicolet's Watch Tower
- R. Windermere/Biddle Point
- S. Point aux Pins
- T. Boardwalk
- U. View of the Harbor & Island from Harbor
- V. Round Island
- W. Cave in the Woods
- X. Croghan's Water
- Y. Fenwick's Cache
- Z. Pulpit Rock/Vista Rock

Figure A-1
Historic & Scenic Sites Map

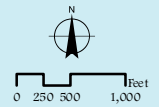

Historic, Geologic and Scenic Sites:

- | | |
|---|---|
| A | Arch Rock |
| B | Sugarloaf |
| C | Robinson's Folly |
| D | Lower's Leap |
| E | Sunset Rock |
| F | Altar Rock/Tabernacle Rock/Friendship's Altar |
| G | Anne's Tablet |
| H | Father Marquette Statue |
| I | British Landing Trail |
| J | Wildflower Walk Trail |
| K | Devil's Kitchen |
| L | Brown's Brook |
| M | Dwightwood Spring |
| N | Lookout Point |
| O | Crack in the Island |
| P | Pontiac's Lookout |
| Q | Nicole's Watch Tower |
| R | Windermere/Biddle Point |
| S | Fort Aux Pins |
| T | Boardwalk |
| U | View of the Harbor & Island from Harbor |
| V | Round Island |
| W | Cave in the Woods |
| X | Croghan's Waters |
| Y | Fenwick's Cache |
| Z | Pulpit Rock/Vista Rock |

Registered Historic Sites:

- | | |
|----|--|
| 1 | Agency House/Stuart House |
| 2 | American Fur Co. Retail Store |
| 3 | Battlefield of 1814 |
| 4 | Beaumont Memorial |
| 5 | Biddle House |
| 6 | British Cannon Site |
| 7 | British Landing |
| 8 | Cudaly Residence/Williams Summer Home |
| 9 | Davenport House |
| 10 | Davis-Preston House/Haan House |
| 11 | Early French Missionary Chapel |
| 12 | Fort Holmes |
| 13 | Fort Mackinac |
| 14 | Geary House |
| 15 | Grand Hotel |
| 16 | Indian Dormitory/Mackinac Art Museum |
| 17 | Island House |
| 18 | Lake View House/Hotel |
| 19 | Mackinac Conference Informational Site |
| 20 | Mackinac Island |
| 21 | Market Street |
| 22 | Mission Church |
| 23 | Mission House |
| 24 | Round Island Lighthouse Informational Designation |
| 25 | Saint Anne's Catholic Church |
| 26 | Silver Birches |
| 27 | Skull Cave |
| 28 | Stuart Office Bldg./Mackinac Island Town Crier Bldg. |
| 29 | Trinity Episcopal Church |
| 30 | Union Congregational Church/Little Stone Church |
| 31 | Wawashkamo Golf Club |
| 32 | Young Cottage/Governor's Summer Residence |

City of
Mackinac Island
Mackinac County, Michigan

Master Plan

- | | |
|---|-------------------------------------|
| ▲ | Registered Historic Sites |
| ● | Historic, Geologic and Scenic Sites |

Property Line Source: Mackinac County Equalization
Historic Sites Source: City of Mackinac Island Master Plan (1999)

- | | |
|---|---------------------------|
| — | State Highway |
| — | Improved (Asphalt) Roads |
| — | Unimproved (Gravel) Roads |
| — | Property Lines |
| ■ | Water Bodies |

September 2010

WADETRIM
271 West McCoy Rd
Gaylord, MI 49735
www.WadeTrim.com

Appendix B Natural Resources

- Mackinac Island State Park Checklists

CHECKLIST

OF THE WILDFLOWERS OF MACKINAC ISLAND



During the past 200 years amateur and professional botanists have identified more than 600 species of wild plants on Mackinac Island. Less than half of those species are considered wildflowers. This checklist includes 270 species of "wildflowers" that are presently found on Mackinac Island.

THE CHECKLIST OF WILDFLOWERS OF MACKINAC ISLAND

A variety of habitats including: northern hardwood forests, conifer forests, fields, meadows, wetlands and beaches make up Mackinac Island's 2,100 acres. Mackinac Island State Park covers about 82% of the island, and the wildflowers growing in the State Park are protected by law and should not be picked or disturbed.

Whether a particular wild plant is considered a wildflower is a matter of opinion. A wildflower to one person may be a weed to someone else. In this checklist we included all of the island's wild plants that are considered to be wildflowers in today's popular field guides. The common names listed here are those most generally used in Michigan, and the scientific or botanical names are those accepted by botanists worldwide. Introduced species are indicated by an asterisk (*).

COMMON NAME SCIENTIFIC NAME

Family Araceae (Arum Family)

- ☐ Jack-in-the-Pulpit (Indian Turnip)

Family Liliaceae (Lily Family)

- ☐ Solomon's Seal, Hairy

- ☐ Twisted Stalk, White

- ☐ Twisted Stalk, Rose (Rosybell)

- ☐ Trillium, Common

- ☐ Lily, Yellow Trout (Adder's tongue)

- ☐ Lily, Wood

- ☐ Lily, Orange Day

- ☐ Lily, Bluebead (Clintonia)

- ☐ Leek, Wild

- ☐ Lily-of-the-valley, Wild

- ☐ Solomon's Seal, False

- ☐ Solomon's Seal, Starry False

- ☐ Camas, White (Death Camas)

- ☐ Lily-of-the-valley

- ☐ Sticky False Asphodel

- ☐ Family Iridaceae (Iris Family)

- ☐ Blue-eyed-grass

- ☐ Dwarf Lake Iris

- ☐ Wild Blue Flag (Blue Iris)

- ☐ Family Orchidaceae (Orchid Family)

- ☐ Lady's-slipper, Yellow

- ☐ Orchid, Calypso

- ☐ Orchid, Bracted

- ☐ Orchid, Round-leaved

- ☐ Orchid, Tall Northern Bog

- ☐ Orchid, Tall White Bog

- ☐ Coral-root, Spotted

- ☐ Coral-root, Northern (Early)

- ☐ Coral-root, Striped

- ☐ Helleborine, Broad-leaved

- ☐ Orchid, Fen (Loesel's Twayblade)
- ☐ Rattlesnake-plantain, Green-leaved
- ☐ Ladies-Tresses, Hooded

Family Santalaceae (Sandalwood Family)

- ☐ Bastard-toadflax

Family Polygonaceae (Smartweed or Buckwheat Family)

- ☐ Field Sorrel (Green or Sheep Sorrel)

- ☐ Rumex acetosella L.*

- ☐ Water Smartweed

Family Chenopodiaceae (Goosefoot family)

- ☐ Lamb's Quarters (pigweed)

- ☐ Strawberry Blight

Family Portulacaceae (Purslane Family)

- ☐ Spring-beauty

- ☐ Spring-beauty, Broad-leaved

- ☐ Common Purslane

Family Caryophyllaceae (Pink Family)

- ☐ Chickweed, Common

- ☐ Sweet William

- ☐ Bouncing Bet (Soapwort)

- ☐ Sweet-William Catchfly

- ☐ Campion, Bladder

- ☐ Campion, White

- ☐ Godron & Gren.*

Family Ranunculaceae (Crowfoot or Buttercup Family)

- ☐ Virgin's Bower (Old Man's Beard)

- ☐ Wild Columbine

- ☐ Meadow-rue, Early

- ☐ Baneberry, Red

- ☐ Baneberry, White (Doll's-eyes)

- ☐ Goldthread

- ☐ Liverleaf, Sharp-lobed (Hepatica)

- ☐ Liverleaf, Round-lobed (Hepatica)

- ☐ Buttercup, Small-flowered

- ☐ Buttercup, Tall

- ☐ Marsh-marigold (Cowslip)

- ☐ Anemone, Canada

- ☐ Anemone, Wood

- ☐ Thimbleweed

Family Berberidaceae (Barberry Family)

- ☐ Blue Cohosh (Papoos-root)

- ☐ Caulophyllum thalictroides (L.) Michx.

Family Papaveraceae (Poppy Family)

- ☐ Bloodroot

- ☐ Celandine

Family Fumariaceae (Fumitory or Bleeding Heart Family)

- ☐ Dutchman's-breeches

Family Brassicaceae (Cruciferae) (Mustard Family)

- ☐ Mustard, Dog

- ☐ Yellow-Rocket (Winter Cress)

- ☐ Yellow Rocket (Native Winter Cress)

- ☐ Mustard, Wild

- ☐ Toothwort, Cut-leaved

- ☐ Dentaria laciniata Willd.

- ☐ Erucastrum gallicum (Willd.) Schultz*

- ☐ Barbarea vulgaris R.Br.*

- ☐ Barbarea orthoceras Ledeb.

- ☐ Brassica kaber (DC.) Wheeler.

Family Ericaceae (Heath Family)

- ☐ Trailing Arbutus
- ☐ Wintergreen (Checkerberry)
- ☐ Bearberry (Kinnikinnick)

Family Primulaceae (Primrose Family)

- ☐ Bird's-eye Primrose
 - ☐ Star-flower
- Family Gentianaceae (Gentian Family)**
- ☐ Gentian, Small Fringed
 - ☐ Gentian, Spurred
- Family Apocynaceae (Dogbane Family)**
- ☐ Periwinkle (Myrtle)
- Family Asclepiadaceae (Milkweed Family)**
- ☐ Milkweed, Common
- Family Boraginaceae (Borage or Forget-me-not Family)**
- ☐ Blueweed (Viper's Bugloss)
 - ☐ Gromwell
 - ☐ Forget-me-not
 - ☐ Hound's-tongue
 - ☐ Northern Wild Comfrey
 - ☐ Beggar's-ice
 - ☐ European Stickseed
- Family Verbenaceae (Vervain Family)**
- ☐ Blue Vervain
- Family Lamiaceae (Labiatae) (Mint Family)**
- ☐ Catnip
 - ☐ Ground-ivy
 - ☐ Self-heal (Heal-all)
 - ☐ Hemp-nettle, Common
 - ☐ Motherwort, Common
 - ☐ BeeBalm (Oswego-tea)
 - ☐ Downy Wood Mint
 - ☐ Low Calamint
- Family Solanaceae (Nightshade or Tomato Family)**
- ☐ Dogmint (Wild Basil)
 - ☐ Bugle Weed
 - ☐ Water-horehound
 - ☐ Mint, Wild
 - ☐ Spearmint
 - ☐ Peppermint
- Family Scrophulariaceae (Figwort or Snapdragon Family)**
- ☐ Bittersweet Nightshade
 - ☐ Black Henbane
- Family Mimulus (Monkey-flower)**
- ☐ James' Mimulus (Monkey-flower)
 - ☐ Mullen, Common
 - ☐ Beard-tongue
 - ☐ Butter-and-Eggs
 - ☐ Yellow Foxglove
 - ☐ Speedwell, Persian
 - ☐ Speedwell, Common
- Family Epigaea repens L.**
- Gaultheria procumbens L.**
- Arctostaphylos uva-ursi (L.) Spreng.**
- Primula mistassinica Michaux.**
- Trientalis borealis Raf.**
- Gentiana procera Holm.**
- Halenia deflexa (Sm.) Griseb.**
- Vinca minor L.**
- Asclepias syriaca L.**
- Echium vulgare L.**
- Lithospermum officinale L.**
- Myosotis arvensis (L.) Hill.**
- Cynoglossum officinale L.**
- Cynoglossum boreale Fern.**
- Hackelia virginiana (L.) Johnston.**
- Lappula echinata Glib.**
- Verbena hastata L.**
- Nepeta cataria L.**
- Glechoma hederacea L.**
- Prunella vulgaris L.**
- Galeopsis tetrahit L.**
- Leonurus cardiaca L.**
- Monarda didyma L.**
- Blephilia ciliata (L.) Benth.**
- Satureja glabella (Michaux) Briquet.**
- Satureja vulgaris (L.) Frish.**
- Lycopus virginicus L.**
- Lycopus americanus L.**
- Mentha arvensis L.**
- Mentha spicata L.**
- Mentha piperita L.**
- Solanum dulcamara L.**
- Hyoscyamus niger L.**
- Mimulus glaberrimus HBK.**
- Mimulus lewisii Pursh.**
- Veronica perfoliata L.**
- Veronica officinalis L.**

Family Saxifragaceae (Saxifrage Family)

- ☐ Toothwort, Broadleaf (Peppervort)
 - ☐ Watercress
 - ☐ Shepherd's purse
- Family Rosaceae (Rose Family)**
- ☐ Rock Cress, Hairy
 - ☐ Rock Cress, Wall
 - ☐ Dame's Rocket (Sweet Rocket)
 - ☐ Hoary Alyssum
 - ☐ Twisted Whitlow-grass
 - ☐ Pepper-grass
 - ☐ Sea-rocket
- Family Crassulaceae (Orpine or Sedum Family)**
- ☐ Mossy Stonecrop (Gold Moss)
- Family Saxifragaceae (Saxifrage Family)**
- ☐ Grass-of-Parnassus
 - ☐ Two-leaved Bishop's-Cap (Miterwort)
 - ☐ Naked Miterwort
 - ☐ Foamflower (False Miterwort)
- Family Rubiaceae (Rose Family)**
- ☐ Thimbleberry
 - ☐ Raspberry, Wild Red
 - ☐ Rose, Prairie
 - ☐ Rose, Wild (Prickly Wild Rose)
 - ☐ Rose, Meadow (Smooth Rose)
 - ☐ Meadow-sweet
 - ☐ Strawberry, Woodland
 - ☐ Strawberry, Wild
 - ☐ Cinquefoil, Shrubby
 - ☐ Silverweed
 - ☐ Cinquefoil, Rough
 - ☐ Cinquefoil, Rough-fruited (Sultur)
 - ☐ Avena, Water
 - ☐ Avena, White
 - ☐ Avena, Yellow
 - ☐ Tall Hairy Agrimony
- Family Leguminosae (Fabaceae) (Pea Family)**
- ☐ Sweet-clover, White
 - ☐ Sweet-clover, Yellow
 - ☐ Clover, Red
 - ☐ Clover, White
 - ☐ Clover, Alsike
 - ☐ Clover, Hop
 - ☐ Black Medick
 - ☐ Beach Pea
 - ☐ Marsh Vetchling
 - ☐ Everlasting Pea
 - ☐ Vetch, Common
 - ☐ Birdfoot Trefoil.
 - ☐ Crown Vetch
- Family Oxalidaceae (Wood-sorrel Family)**
- ☐ Lady's Sorrel (Creeping Wood-sorrel)
- Family Geraniaceae (Geranium Family)**
- ☐ Herb Robert (Red Robin)
- Dentaria diphylla Michaux.**
- Nasturtium officinale R.Br.**
- Capsella bursa-pastoris (L.) Medicus.**
- Arabis hirsuta (L.) Scop.**
- Arabis caucasica Schlecht.**
- Hesperis matronalis L.**
- Berteroa incana (L.) DC.**
- Draba arabisans Michx.**
- Lepidium campestre (L.) R. Br.**
- Cakile edentula (Bigelow) Hooker.**
- Sedum acre L.**
- Parnassia glauca Raf.**
- Mitella diphylla L.**
- Mitella nuda L.**
- Tiarella cordifolia L.**
- Rubus parviflorus Nutt.**
- Rubus strigosus Michaux.**
- Rosa arkansana Porter.**
- Rosa acicularis Lindley.**
- Rosa blanda Aiton.**
- Spiraea alba Du Roi.**
- Fragaria vesca L.**
- Fragaria virginiana Miller.**
- Potentilla fruticosa L.**
- Potentilla anserina L.**
- Potentilla norvegica L.**
- Potentilla recta L.**
- Geum rivale L.**
- Geum canadensis Jacq.**
- Geum aleppicum Jacq.**
- Agrimonia gryposepala Wallr.**
- Meilolus alba Medicus.**
- Mellilotus officinalis (L.) Pallas.**
- Trifolium pratense L.**
- Trifolium repens L.**
- Trifolium hybridum L.**
- Trifolium aureum Pol.**
- Medicago lupulina L.**
- Lathyrus japonicus Willd.**
- Lathyrus palustris L.**
- Lathyrus latifolius L.**
- Vicia sativa L.**
- Lotus corniculata L.**
- Coronilla varia L.**

Family Polygalaceae (Milkwort Family)

- ☐ Fringed Polygala (Gay-wings)
- Family Euphorbiaceae (Spurge Family)**
- ☐ Spurge, Cypress
 - ☐ Spurge, Petty
- Family Balsaminaceae (Touch-me-not Family)**
- ☐ Jewelweed (Spotted Touch-me-not)
- Family Malvaceae (Mallow Family)**
- ☐ Mallow, Common (Cheeses)
 - ☐ Mallow, Musk
 - ☐ Hollyhock
- Family Clusiaceae (Guttiferae) (St. John's-wort Family)**
- ☐ St. John's-wort, Kalm's
 - ☐ St. John's-wort, Common
- Family Violaceae (Violet Family)**
- ☐ Johnny-jump-up
 - ☐ Violet, Downy Yellow
 - ☐ Violet, Canada
 - ☐ Violet, Long-spurred
 - ☐ Violet, American Dog
 - ☐ Violet, Kidney leaved
 - ☐ Violet, Great-spurred
 - ☐ Violet, Small Mottled
 - ☐ Violet, Common Blue
- Family Lythraceae (Loosestrife Family)**
- ☐ Purple Loosestrife
- Family Onagraceae (Evening-primrose Family)**
- ☐ Small Enchanter's-nightshade
 - ☐ Fireweed (Great Willow-herb)
 - ☐ Northern Willow-herb
 - ☐ Evening-primrose, Common
- Family Araliaceae (Ginseng Family)**
- ☐ Spikenard
 - ☐ Wild Sarsaparilla
- Family Apiaceae (Umbelliferae) (Parsley or carrot Family)**
- ☐ Black Shakeroot
 - ☐ Wild Carrot (Queen-Anne's-lace)
 - ☐ Sweet-cicely
 - ☐ Cow-parsnip
 - ☐ Wild Parsnip
 - ☐ Posion-hemlock
 - ☐ Yellow-pimpernel
 - ☐ Water-hemlock
- Family Cornaceae (Dogwood Family)**
- ☐ Bunchberry.
- Family Ericaceae (Heath Family)**
- ☐ Indian Pipe
 - ☐ Prince's Pine (Pipsissewa)
 - ☐ Shinleaf, One-sided (Sidebells)
 - ☐ Shinleaf, Liver-leaf (Pink Pyrola)
 - ☐ Shinleaf
- Monotropa uniflora L.**
- Chimaphila umbellata (L.) Bart.**
- Pyrola secunda L.**
- Pyrola asarifolia Michaux.**
- Pyrola elliptica Nutt.**

(continued)

- ☐ American Brooklime (Speedwell) Veronica americana (Raf.) Schwein.
- ☐ Small-flowered Gerardia Gerardia purpurea L.
- ☐ Wood Betony (Lousewort) Pseudoficaria canadensis L.
- ☐ Indian Paintbrush (Painted Cup) Castilleja coccinea (L.) Spring.
- Family Orobanchaceae (Broomrape Family)**
- ☐ Cancer-root Orobancha uniflora L.
- ☐ Squaw-root Conopholis americana (L.) Wallr.
- ☐ Beach-drops Epiplatys virginiana (L.) Bart.
- Family Plantaginaceae (Plantain Family)**
- ☐ Plantain, Common Plantago major L.*
- ☐ Plantain, English Plantago lanceolata L.*
- ☐ Plantain, Rugel's Plantago rugelii DeCne.*
- Family Rubiaceae (Madder or Bedstraw Family)**
- ☐ Partridge Berry Mitchella repens L.
- ☐ Cleavers Galium aparine L.
- ☐ Bedstraw, Small Galium trifidum L.
- ☐ Bedstraw, Sweet-scented Galium triflorum Michaux.
- Family Caprifoliaceae (Honeysuckle Family)**
- ☐ Twin Flower Linnaea borealis L.
- Family Valerianaceae (Valerian Family)**
- ☐ Garden Valerian (Garden Heliotrope) Valeriana officinalis L.*
- Family Campanulaceae (Harebell or Bluebell Family)**
- ☐ Harebell (Bluebell) Campanula rotundifolia L.
- ☐ Harebell, Creeping (Bellflower) Campanula rapunculoides L.*
- ☐ Harebell, Marsh (Bellflower) Campanula asperifoloides Prush.
- ☐ Garden Campanula Campanula persicifolia L.*
- Family Lobeliaceae (Lobelia Family)**
- ☐ Brook Lobelia Lobelia kalmii L.
- Family Compositae (Asteraceae) (Composite or Daisy Family)**
- ☐ Jerusalem Artichoke Helianthus tuberosus L.*
- ☐ Black-eyed Susan Rudbeckia hirta L.
- ☐ Beggar-ticks Bidens frondosa L.
- ☐ Lance-leaved Coreopsis (Tickseed) Coreopsis lanceolata L.
- ☐ Ragweed, Common Ambrosia artemisiifolia L.
- ☐ Mayweed (Chamomile or Dogfennel) Anthemis cotula L.*
- ☐ Yarrow, Common (Milfoil) Achillea millefolium L.*
- ☐ Ox-eye Daisy Chrysanthemum leucanthemum L.
- ☐ Tansy, Common Tanacetum vulgare L.*
- ☐ Pineappleweed Matricaria matricarioides (Less) Porter*
- ☐ Tall Wormwood Artemisia campestris L.
- ☐ Ragwort, Common (Groundsel) Senecio vulgaris L.*
- ☐ Ragwort, Golden Senecio aureus L.
- ☐ Ragwort, Balsam (Groundsel) Senecio pauperculus Michaux.
- ☐ Palmate-leaved Sweet-colt's Foot Patasites frigidus (L.) Fries.
- ☐ Goldenrod, Hairy Solidago hispida Muhl.
- ☐ Goldenrod, Zigzag Solidago flexicaulis L.
- ☐ Goldenrod, Canada Solidago canadensis L.
- ☐ Goldenrod, Tall Solidago altissima L.

- ☐ Goldenrod, Ohio Solidago ohioensis Riddell.
- ☐ Goldenrod, Grass-leaved Solidago graminifolia L.
- ☐ Goldenrod, Houghton's Solidago houghtonii T. & G.
- ☐ Aster, Large-leaved Aster macrophyllus L.
- ☐ Aster, Lingley's Aster ciliolatus Lind.
- ☐ Aster, Arrow-leaved Aster sagittifolius Willd.
- ☐ Aster, Punctate Aster punctatus L.
- ☐ Aster, Pilosus Aster pilosus Willd.
- ☐ Philadelphia Fleabane Erigeron philadelphicus L.
- ☐ Sweet Scabious (White-top) Erigeron annuus (L.) Pers.
- ☐ Daisy Fleabane Erigeron strigosus Muhl.
- ☐ English Daisy (Garden Daisy) Bellis perennis L.*
- ☐ Pussytoes Antennaria sp.
- ☐ Pearly Everlasting Anaphalis margaritacea (L.) Benth & Hook.
- ☐ Joe-Pye Weed Eupatorium maculatum L.
- ☐ Common Burdock Arctium minus Schk.*
- ☐ Thistle, Bull Cirsium vulgare (Savi.) Tenore.
- ☐ Thistle, Pitcher's Cirsium pitcheni (Torr.) T. & G.*
- ☐ Thistle, Field Cirsium discolor (Muhl.) Spreng.
- ☐ Thistle, Canada Cirsium anvense (L.) Scop.*
- ☐ Spotted Knapweed Centaurea maculosa Lam.*
- ☐ Perennial Cornflower (Ragged Robin) Centaurea montana L.*
- ☐ Lettuce, White Prenanthes alba L.
- ☐ Hawkweed, Rough Hieracium scabrum Michaux.
- ☐ Hawkweed, Hairy Hieracium gronovii L.
- ☐ Hawkweed, Narrow-leaved Hieracium umbellatum L.
- ☐ Hawkweed, Orange (Devil's Paintbrush) Hieracium aurantiacum L.*
- ☐ Hawkweed, Canada Hieracium canadense Michaux.
- ☐ Hawkweed (Golden Lungwort) Hieracium murorum L.*
- ☐ Dandelion, Common Taraxacum officinale Weber.*
- ☐ Sow-thistle, Spiny-leaved Sonchus asper (L.) Hill.*
- ☐ Lettuce, Wild Lactuca canadensis L.
- ☐ Lettuce, Tall Blue Lactuca biennis (Moench) Fern.
- ☐ Lettuce, Wall Lactuca muralis (L.) Fresen.*
- ☐ Chicory Cichorium intybus L.*
- ☐ Nipple-wort Lapsana communis L.
- ☐ Goat's Beard, Yellow Tragopogon pratensis L.

This checklist is based on the 1995 Masters of Science thesis
"A Floristic Study of the Vascular Plants of Mackinac Island,
Michigan" by Patricia L. Martin.



Michigan Department of
Natural Resources
© Mackinac State Historic Parks

The production of this
checklist was made
Possible by a generous
grant from
Mackinac Associates

Printed on recycled paper

CHECKLIST

OF THE BIRDS

OF MACKINAC ISLAND

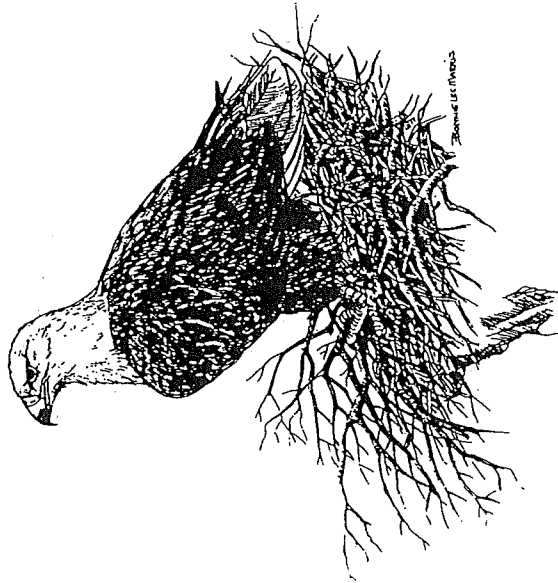

This checklist includes all bird species observed on Mackinac Island or in the surrounding waters of the Straits of Mackinac during the past 15 years. Mackinac Island is 2,100 acres in size and has 8.1 miles of shoreline. Mackinac Island State Park contains 1,773 of these acres and includes 5 miles of the shoreline.

Birds can be observed in a variety of habitats in the park:

- The northern hardwood forest, which covers much of the park's interior. (american beech, sugar maple, eastern hemlock, northern red oak, and white pine)
- Lowland conifer forests near the shoreline and in damp areas throughout the park. (northern white cedar, balsam fir, white spruce, red pine and paper birch)
- Open areas, such as the fields and meadows near the airport, and Wawashkamo golf course.
- Wetlands, such as Croghan's Water marsh.

Family	Species
Loons	<input type="checkbox"/> Red-throated Loon <input type="checkbox"/> Common Loon
Grebes	<input type="checkbox"/> Horned Grebe <input type="checkbox"/> Red-necked Grebe
Cormorants	<input type="checkbox"/> Double-crested Cormorant
Hérons, Bitterns	<input type="checkbox"/> American Bittern <input type="checkbox"/> Great Blue Heron <input type="checkbox"/> Green-backed Heron <input type="checkbox"/> Black-crowned Night-Heron
Swans, Geese, Ducks	<input type="checkbox"/> Tundra Swan <input type="checkbox"/> Mute Swan <input type="checkbox"/> Snow Goose <input type="checkbox"/> Canada Goose <input type="checkbox"/> Wood Duck <input type="checkbox"/> American Black Duck <input type="checkbox"/> Mallard <input type="checkbox"/> Blue-winged Teal <input type="checkbox"/> Redhead <input type="checkbox"/> Ring-necked Duck <input type="checkbox"/> Greater Scaup <input type="checkbox"/> Lesser Scaup <input type="checkbox"/> Oldsquaw <input type="checkbox"/> White-winged Scoter <input type="checkbox"/> Common Goldeneye <input type="checkbox"/> Bufflehead <input type="checkbox"/> Common Merganser <input type="checkbox"/> Red-breasted Merganser
Vultures	<input type="checkbox"/> Turkey Vulture
Ospreys, Eagles, Harriers, Hawks	<input type="checkbox"/> Osprey <input type="checkbox"/> Bald Eagle <input type="checkbox"/> Northern Harrier <input type="checkbox"/> Sharp-shinned Hawk <input type="checkbox"/> Cooper's Hawk <input type="checkbox"/> Northern Goshawk <input type="checkbox"/> Red-shouldered Hawk <input type="checkbox"/> Broad-winged Hawk <input type="checkbox"/> Red-tailed Hawk <input type="checkbox"/> Rough-legged Hawk
Falcons	<input type="checkbox"/> American Kestrel <input type="checkbox"/> Merlin
Grouse	<input type="checkbox"/> Ring-necked Pheasant
Rails, Coots	<input type="checkbox"/> Virginia Rail <input type="checkbox"/> Sora <input type="checkbox"/> American Coot
Cranes	<input type="checkbox"/> Sandhill Crane



Family	Species
Plovers	<input type="checkbox"/> Killdeer
Sandpipers	<input type="checkbox"/> Solitary Sandpiper <input type="checkbox"/> Spotted Sandpiper <input type="checkbox"/> Common Snipe <input type="checkbox"/> American Woodcock
Gulls, Terns	<input type="checkbox"/> Bonaparte's Gull <input type="checkbox"/> Ring-billed Gull <input type="checkbox"/> Herring Gull <input type="checkbox"/> Great Black-backed Gull <input type="checkbox"/> Caspian Tern <input type="checkbox"/> Common Tern <input type="checkbox"/> Black Tern
Pigeons, Doves	<input type="checkbox"/> Rock Dove <input type="checkbox"/> Mourning Dove
Cuckoos	<input type="checkbox"/> Black-billed Cuckoo <input type="checkbox"/> Yellow-billed Cuckoo
Owls	<input type="checkbox"/> Great Horned Owl <input type="checkbox"/> Snowy Owl <input type="checkbox"/> Barred Owl <input type="checkbox"/> Great Gray Owl <input type="checkbox"/> Long-eared Owl <input type="checkbox"/> Boreal Owl <input type="checkbox"/> Northern Saw-whet Owl
Goatsuckers	<input type="checkbox"/> Common Nighthawk <input type="checkbox"/> Whip-poor-will
Swifts	<input type="checkbox"/> Chimney Swift
Hummingbirds	<input type="checkbox"/> Ruby-throated Hummingbird
Kingfishers	<input type="checkbox"/> Belted Kingfisher
Woodpeckers	<input type="checkbox"/> Red-headed Woodpecker <input type="checkbox"/> Yellow-bellied Sapsucker <input type="checkbox"/> Downy Woodpecker <input type="checkbox"/> Hairy Woodpecker <input type="checkbox"/> Black-backed Woodpecker <input type="checkbox"/> Northern Flicker <input type="checkbox"/> Pileated Woodpecker
Flycatchers	<input type="checkbox"/> Olive-sided Flycatcher <input type="checkbox"/> Eastern Wood-Pewee <input type="checkbox"/> Yellow-bellied Flycatcher <input type="checkbox"/> Alder Flycatcher <input type="checkbox"/> Willow Flycatcher <input type="checkbox"/> Least Flycatcher <input type="checkbox"/> Eastern Phoebe <input type="checkbox"/> Great Crested Flycatcher <input type="checkbox"/> Eastern Kingbird

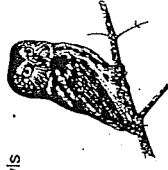

Family	Species
Dowling Warblers	Golden-winged Warbler <input type="checkbox"/>
	Tennessee Warbler <input type="checkbox"/>
	Orange-crowned Warbler <input type="checkbox"/>
	Nashville Warbler <input type="checkbox"/>
	Northern Parula <input type="checkbox"/>
	Yellow Warbler <input type="checkbox"/>
	Chestnut-sided Warbler <input type="checkbox"/>
	Magnolia Warbler <input type="checkbox"/>
	Cape May Warbler <input type="checkbox"/>
	Black-throated Blue Warbler <input type="checkbox"/>
	Yellow-rumped Warbler <input type="checkbox"/>
	Black-throated Green Warbler <input type="checkbox"/>
	Blackburnian Warbler <input type="checkbox"/>
	Pine Warbler <input type="checkbox"/>
	Prairie Warbler <input type="checkbox"/>
	Palm Warbler <input type="checkbox"/>
	Bay-breasted Warbler <input type="checkbox"/>
	Blackpoll Warbler <input type="checkbox"/>
	Black-and-white Warbler <input type="checkbox"/>
	American Redstart <input type="checkbox"/>
Overbird <input type="checkbox"/>	
Northern Waterthrush <input type="checkbox"/>	
Connecticut Warbler <input type="checkbox"/>	
Mourning Warbler <input type="checkbox"/>	
Common Yellowthroat <input type="checkbox"/>	
Wilson's Warbler <input type="checkbox"/>	
Canada Warbler <input type="checkbox"/>	



Scarlet Tanager <input type="checkbox"/>
Northern Cardinal <input type="checkbox"/>
Rose-breasted Grosbeak <input type="checkbox"/>
Indigo Bunting <input type="checkbox"/>
Dickcissel <input type="checkbox"/>
Rufous-sided Towhee <input type="checkbox"/>
American Tree Sparrow <input type="checkbox"/>
Chipping Sparrow <input type="checkbox"/>
Field Sparrow <input type="checkbox"/>
Vesper Sparrow <input type="checkbox"/>
Savannah Sparrow <input type="checkbox"/>
Fox Sparrow <input type="checkbox"/>
Song Sparrow <input type="checkbox"/>
Swamp Sparrow <input type="checkbox"/>
White-throated Sparrow <input type="checkbox"/>
White-crowned Sparrow <input type="checkbox"/>
Dark-eyed Junco <input type="checkbox"/>
Lapland Longspur <input type="checkbox"/>
Snow Bunting <input type="checkbox"/>

Family	Species
Meadowlarks, Blackbirds, Orols	Bobolink <input type="checkbox"/>
	Red-winged Blackbird <input type="checkbox"/>
	Eastern Meadowlark <input type="checkbox"/>
	Rusty Blackbird <input type="checkbox"/>
	Brewer's Blackbird <input type="checkbox"/>
	Common Grackle <input type="checkbox"/>
	Brown-headed Cowbird <input type="checkbox"/>
	Northern Oriole <input type="checkbox"/>



Finches	Pine Grosbeak <input type="checkbox"/>
	Purple Finch <input type="checkbox"/>
	House Finch <input type="checkbox"/>
	Red Crossbill <input type="checkbox"/>
	White-winged Crossbill <input type="checkbox"/>
	Common Redpoll <input type="checkbox"/>
	Pine Siskin <input type="checkbox"/>
	American Goldfinch <input type="checkbox"/>
	Evening Grosbeak <input type="checkbox"/>
Weaver Finches	House Sparrow <input type="checkbox"/>

We would appreciate your comments and reports of your observations. You may report your findings to the Park Naturalist at the British-Landing Nature Center or to the staff in the Mackinac State Historic Parks Visitor's Center. Sightings of rare or unlisted species should be reported with written details and/or photographic documentation. Island cottager: Hayden Hannabass provided valuable assistance in putting this checklist together.

Jeff Dykehouse
Park Naturalist
Mackinac State Historic Parks
P.O. Box 873
Mackinaw City, MI 49701

Date: _____

Observer: _____

Notes: _____

Family	Species
Larks	Horned Lark <input type="checkbox"/>
Swallows	Purple Martin <input type="checkbox"/>
	Tree Swallow <input type="checkbox"/>
	Northern Rough-winged Swallow <input type="checkbox"/>
	Bank Swallow <input type="checkbox"/>
	Cliff Swallow <input type="checkbox"/>
	Barn Swallow <input type="checkbox"/>
Jays, Crows	Blue Jay <input type="checkbox"/>
	American Crow <input type="checkbox"/>
	Common Raven <input type="checkbox"/>
Chickadees, Titmice	Black-capped Chickadee <input type="checkbox"/>
	Tufted Titmouse <input type="checkbox"/>
Nuthatches	Red-breasted Nuthatch <input type="checkbox"/>
	White-breasted Nuthatch <input type="checkbox"/>
Creepers	Brown Creeper <input type="checkbox"/>
Wrens	House Wren <input type="checkbox"/>
	Winter Wren <input type="checkbox"/>
Kinglets; Gnatcatchers	Golden-crowned Kinglet <input type="checkbox"/>
	Ruby-crowned Kinglet <input type="checkbox"/>
	Blue-gray Gnatcatcher <input type="checkbox"/>
Thrushes	Eastern Bluebird <input type="checkbox"/>
	Veery <input type="checkbox"/>
	Swainson's Thrush <input type="checkbox"/>
	Hermit Thrush <input type="checkbox"/>
	Wood Thrush <input type="checkbox"/>
	American Robin <input type="checkbox"/>
Mockingbirds, Thrashers	Gray Catbird <input type="checkbox"/>
	Brown Thrasher <input type="checkbox"/>
Waxwings	Bohemian Waxwing <input type="checkbox"/>
	Cedar Waxwing <input type="checkbox"/>
Shrikes	Northern Shrike <input type="checkbox"/>
Starlings	European Starling <input type="checkbox"/>
Vireos	Solitary Vireo <input type="checkbox"/>
	Yellow-throated Vireo <input type="checkbox"/>
	Warbling Vireo <input type="checkbox"/>
	Philadelphia Vireo <input type="checkbox"/>
	Red-eyed Vireo <input type="checkbox"/>



Michigan Department of Natural Resources
Mackinac State Historic Parks

printed on recycled paper

Appendix C

Mackinac Island Airport Layout Plan

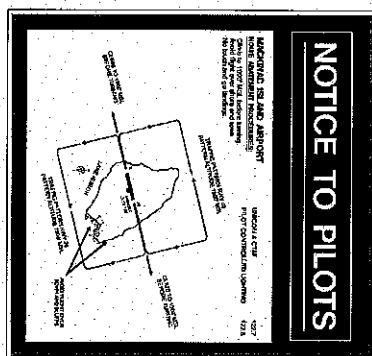
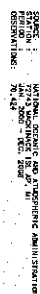
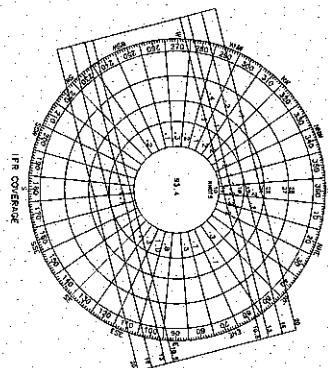
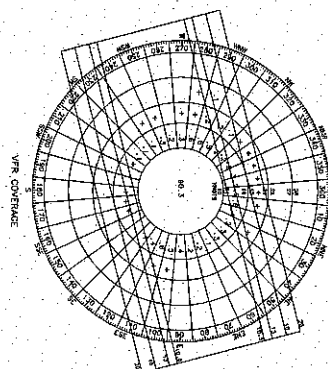
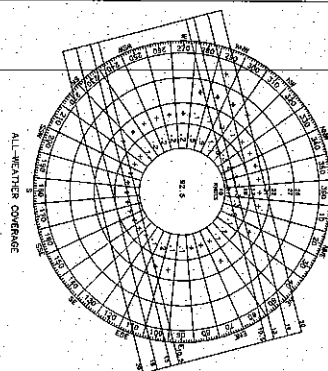
[illegible][illegible]

WIND		COVER		COVER		SUMMARY	
		CA	TE	CO	TE	CO	TE
		1	2	1	2	1	2
10 KNOTS	AL-MEAN	99.88					
COVER	VR	99.85					
16 KNOTS	AL-MEAN	99.87					
COVER	VR	99.76					
13 KNOTS	AL-MEAN	99.72					
X-WIND	VR	99.52					
COVER	VR	98.92					
10.5 KNOTS	AL-MEAN	97.07					
X-WIND	VR	96.95					
COVER	VR	97.32					

DATE OF FAS LETTER	DEC 14, 1973	DESCRIPTION	NO LONGER NEEDED. OBJECT REMOVED FORUMS TO REMOVE THE PART 71 OBSTRUCTIONS TO THE RUNWAY PROVIDING CLEAR PROX DISTANCES 118 TO 4.2° PARALLEL AND 118 TO 4.2° PERPENDICULAR RUNWAY CENTERLINE HAS BEEN WAVED APPROX 100' TO 125 SOUTH OF CENTERLINE
DOT NUMBER	DOT 24,193		RECORDED TO REMOVE THE PART 71 OBSTRUCTIONS TO THE RUNWAY CENTERLINE HAS BEEN WAVED APPROX 100' TO 125 SOUTH OF CENTERLINE
AIRL. NO.	AIRL. NO. 7003		WANTS FOR OBJECT FREE AREA (OFA) ON NORTH SIDE OF RUNWAY B AN EXISTING FENCE EXISTS 200' FROM CENTERLINE FOR A DISTANCE OF 695' FROM THE END OF THE WEST END OF THE OFA.
AIRL. NO.	AIRL. NO. 7003		WANTS FOR OBJECT FREE AREA (OFA) ON SOUTH SIDE OF RUNWAY B. AN EXISTING FENCE EXISTS 200' FROM CENTERLINE FOR A DISTANCE OF 77' FROM THE END OF THE WEST END OF THE OFA.

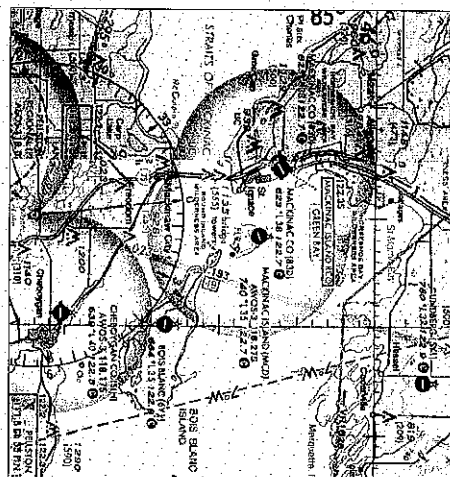
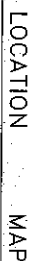
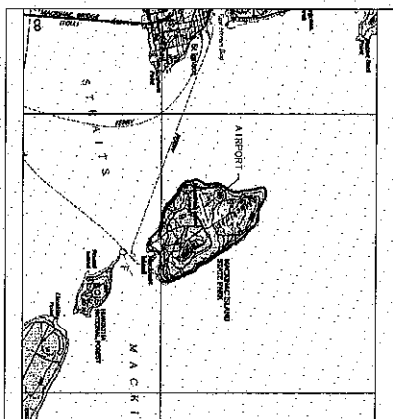
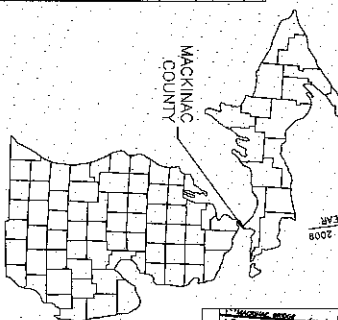

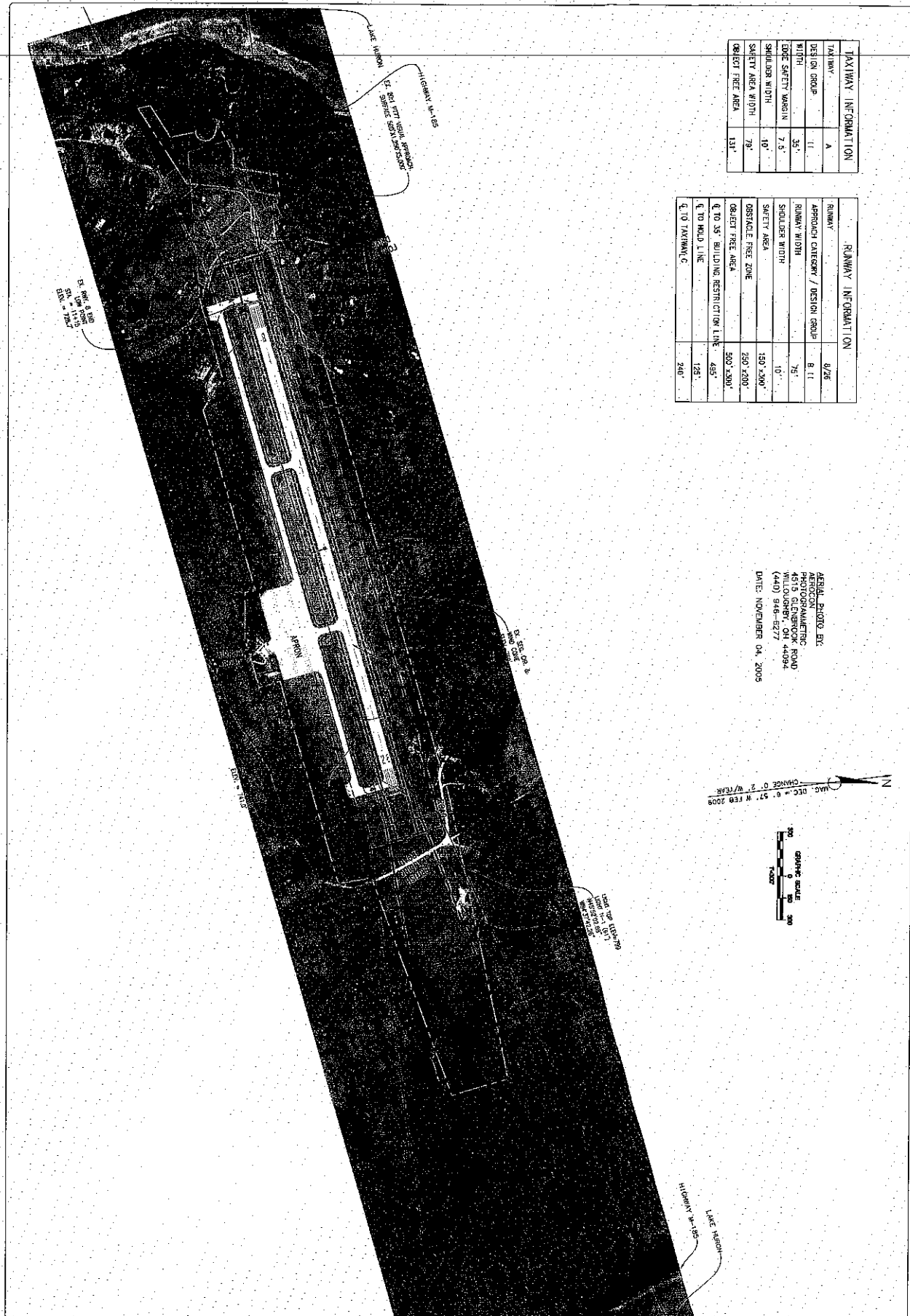

No.	Name	Age	Sex	STATURE										WEIGHT										BLOOD PRESSURE																																																																																																																																																																																																																																																																																																																																																																																																																																																																																																																																																																																																																																																																																																																																																																																																																																																																																																																																																																																																																																																																																																																																																																																																																																																																																																																																																																																																																																																																																																																																																																																																																																																																																																																																																																																																																																																																													
				Height	Weight	Arm	Forearm	Wrist	Hand	Foot	Shoe	Sole	Heel	Ball	Arch	Instep	Ankle	Calf	Thigh	Leg	Knee	Hip	Waist	Neck	Head	Face	Eyes	Nose	Mouth	Lips	Teeth	Tongue	Throat	Larynx	Trachea	Esophagus	Stomach	Liver	Gallbladder	Pancreas	Spleen	Lungs	Heart	Aorta	Ventricle	Artery	Vein	Nerve	Muscle	Bone	Joint	Skin	Hair	Nails	Sweat	Tears	Saliva	Urine	Feces	Semen	Ovary	Uterus	Vagina	Cervix	Vulva	Clitoris	Penis	Scrotum	Testis	Prostate	Bladder	Ureter	Urethra	Rectum	Sigmoid	Colon	Small	Large	Appendix	Gallbladder	Pancreas	Spleen	Lungs	Heart	Aorta	Ventricle	Artery	Vein	Nerve	Muscle	Bone	Joint	Skin	Hair	Nails	Sweat	Tears	Saliva	Urine	Feces	Semen	Ovary	Uterus	Vagina	Cervix	Vulva	Clitoris	Penis	Scrotum	Testis	Prostate	Bladder	Ureter	Urethra	Rectum	Sigmoid	Colon	Small	Large	Appendix	Gallbladder	Pancreas	Spleen	Lungs	Heart	Aorta	Ventricle	Artery	Vein	Nerve	Muscle	Bone	Joint	Skin	Hair	Nails	Sweat	Tears	Saliva	Urine	Feces	Semen	Ovary	Uterus	Vagina	Cervix	Vulva	Clitoris	Penis	Scrotum	Testis	Prostate	Bladder	Ureter	Urethra	Rectum	Sigmoid	Colon	Small	Large	Appendix	Gallbladder	Pancreas	Spleen	Lungs	Heart	Aorta	Ventricle	Artery	Vein	Nerve	Muscle	Bone	Joint	Skin	Hair	Nails	Sweat	Tears	Saliva	Urine	Feces	Semen	Ovary	Uterus	Vagina	Cervix	Vulva	Clitoris	Penis	Scrotum	Testis	Prostate	Bladder	Ureter	Urethra	Rectum	Sigmoid	Colon	Small	Large	Appendix	Gallbladder	Pancreas	Spleen	Lungs	Heart	Aorta	Ventricle	Artery	Vein	Nerve	Muscle	Bone	Joint	Skin	Hair	Nails	Sweat	Tears	Saliva	Urine	Feces	Semen	Ovary	Uterus	Vagina	Cervix	Vulva	Clitoris	Penis	Scrotum	Testis	Prostate	Bladder	Ureter	Urethra	Rectum	Sigmoid	Colon	Small	Large	Appendix	Gallbladder	Pancreas	Spleen	Lungs	Heart	Aorta	Ventricle	Artery	Vein	Nerve	Muscle	Bone	Joint	Skin	Hair	Nails	Sweat	Tears	Saliva	Urine	Feces	Semen	Ovary	Uterus	Vagina	Cervix	Vulva	Clitoris	Penis	Scrotum	Testis	Prostate	Bladder	Ureter	Urethra	Rectum	Sigmoid	Colon	Small	Large	Appendix	Gallbladder	Pancreas	Spleen	Lungs	Heart	Aorta	Ventricle	Artery	Vein	Nerve	Muscle	Bone	Joint	Skin	Hair	Nails	Sweat	Tears	Saliva	Urine	Feces	Semen	Ovary	Uterus	Vagina	Cervix	Vulva	Clitoris	Penis	Scrotum	Testis	Prostate	Bladder	Ureter	Urethra	Rectum	Sigmoid	Colon	Small	Large	Appendix	Gallbladder	Pancreas	Spleen	Lungs	Heart	Aorta	Ventricle	Artery	Vein	Nerve	Muscle	Bone	Joint	Skin	Hair	Nails	Sweat	Tears	Saliva	Urine	Feces	Semen	Ovary	Uterus	Vagina	Cervix	Vulva	Clitoris	Penis	Scrotum	Testis	Prostate	Bladder	Ureter	Urethra	Rectum	Sigmoid	Colon	Small	Large	Appendix	Gallbladder	Pancreas	Spleen	Lungs	Heart	Aorta	Ventricle	Artery	Vein	Nerve	Muscle	Bone	Joint	Skin	Hair	Nails	Sweat	Tears	Saliva	Urine	Feces	Semen	Ovary	Uterus	Vagina	Cervix	Vulva	Clitoris	Penis	Scrotum	Testis	Prostate	Bladder	Ureter	Urethra	Rectum	Sigmoid	Colon	Small	Large	Appendix	Gallbladder	Pancreas	Spleen	Lungs	Heart	Aorta	Ventricle	Artery	Vein	Nerve	Muscle	Bone	Joint	Skin	Hair	Nails	Sweat	Tears	Saliva	Urine	Feces	Semen	Ovary	Uterus	Vagina	Cervix	Vulva	Clitoris	Penis	Scrotum	Testis	Prostate	Bladder	Ureter	Urethra	Rectum	Sigmoid	Colon	Small	Large	Appendix	Gallbladder	Pancreas	Spleen	Lungs	Heart	Aorta	Ventricle	Artery	Vein	Nerve	Muscle	Bone	Joint	Skin	Hair	Nails	Sweat	Tears	Saliva	Urine	Feces	Semen	Ovary	Uterus	Vagina	Cervix	Vulva	Clitoris	Penis	Scrotum	Testis	Prostate	Bladder	Ureter	Urethra	Rectum	Sigmoid	Colon	Small	Large	Appendix	Gallbladder	Pancreas	Spleen	Lungs	Heart	Aorta	Ventricle	Artery	Vein	Nerve	Muscle	Bone	Joint	Skin	Hair	Nails	Sweat	Tears	Saliva	Urine	Feces	Semen	Ovary	Uterus	Vagina	Cervix	Vulva	Clitoris	Penis	Scrotum	Testis	Prostate	Bladder	Ureter	Urethra	Rectum	Sigmoid	Colon	Small	Large	Appendix	Gallbladder	Pancreas	Spleen	Lungs	Heart	Aorta	Ventricle	Artery	Vein	Nerve	Muscle	Bone	Joint	Skin	Hair	Nails	Sweat	Tears	Saliva	Urine	Feces	Semen	Ovary	Uterus	Vagina	Cervix	Vulva	Clitoris	Penis	Scrotum	Testis	Prostate	Bladder	Ureter	Urethra	Rectum	Sigmoid	Colon	Small	Large	Appendix	Gallbladder	Pancreas	Spleen	Lungs	Heart	Aorta	Ventricle	Artery	Vein	Nerve	Muscle	Bone	Joint	Skin	Hair	Nails	Sweat	Tears	Saliva	Urine	Feces	Semen	Ovary	Uterus	Vagina	Cervix	Vulva	Clitoris	Penis	Scrotum	Testis	Prostate	Bladder	Ureter	Urethra	Rectum	Sigmoid	Colon	Small	Large	Appendix	Gallbladder	Pancreas	Spleen	Lungs	Heart	Aorta	Ventricle	Artery	Vein	Nerve	Muscle	Bone	Joint	Skin	Hair	Nails	Sweat	Tears	Saliva	Urine	Feces	Semen	Ovary	Uterus	Vagina	Cervix	Vulva	Clitoris	Penis	Scrotum	Testis	Prostate	Bladder	Ureter	Urethra	Rectum	Sigmoid	Colon	Small	Large	Appendix	Gallbladder	Pancreas	Spleen	Lungs	Heart	Aorta	Ventricle	Artery	Vein	Nerve	Muscle	Bone	Joint	Skin	Hair	Nails	Sweat	Tears	Saliva	Urine	Feces	Semen	Ovary	Uterus	Vagina	Cervix	Vulva	Clitoris	Penis	Scrotum	Testis	Prostate	Bladder	Ureter	Urethra	Rectum	Sigmoid	Colon	Small	Large	Appendix	Gallbladder	Pancreas	Spleen	Lungs	Heart	Aorta	Ventricle	Artery	Vein	Nerve	Muscle	Bone	Joint	Skin	Hair	Nails	Sweat	Tears	Saliva	Urine	Feces	Semen	Ovary	Uterus	Vagina	Cervix	Vulva	Clitoris	Penis	Scrotum	Testis	Prostate	Bladder	Ureter	Urethra	Rectum	Sigmoid	Colon	Small	Large	Appendix	Gallbladder	Pancreas	Spleen	Lungs	Heart	Aorta	Ventricle	Artery	Vein	Nerve	Muscle	Bone	Joint	Skin	Hair	Nails	Sweat	Tears	Saliva	Urine	Feces	Semen	Ovary	Uterus	Vagina	Cervix	Vulva	Clitoris	Penis	Scrotum	Testis	Prostate	Bladder	Ureter	Urethra	Rectum	Sigmoid	Colon	Small	Large	Appendix	Gallbladder	Pancreas	Spleen	Lungs	Heart	Aorta	Ventricle	Artery	Vein	Nerve	Muscle	Bone	Joint	Skin	Hair	Nails	Sweat	Tears	Saliva	Urine	Feces	Semen	Ovary	Uterus	Vagina	Cervix	Vulva	Clitoris	Penis	Scrotum	Testis	Prostate	Bladder	Ureter	Urethra	Rectum	Sigmoid	Colon	Small	Large	Appendix	Gallbladder	Pancreas	Spleen	Lungs	Heart	Aorta	Ventricle	Artery	Vein	Nerve	Muscle	Bone	Joint	Skin	Hair	Nails	Sweat	Tears	Saliva	Urine	Feces	Semen	Ovary	Uterus	Vagina	Cervix	Vulva	Clitoris	Penis	Scrotum	Testis	Prostate	Bladder	Ureter	Urethra	Rectum	Sigmoid	Colon	Small	Large	Appendix	Gallbladder	Pancreas	Spleen	Lungs	Heart	Aorta	Ventricle	Artery	Vein	Nerve	Muscle	Bone	Joint	Skin	Hair	Nails	Sweat	Tears	Saliva	Urine	Feces	Semen	Ovary	Uterus	Vagina	Cervix	Vulva	Clitoris	Penis	Scrotum	Testis	Prostate	Bladder	Ureter	Urethra	Rectum	Sigmoid	Colon	Small	Large	Appendix	Gallbladder	Pancreas	Spleen	Lungs	Heart	Aorta	Ventricle	Artery	Vein	Nerve	Muscle	Bone	Joint	Skin	Hair	Nails	Sweat	Tears	Saliva	Urine	Feces	Semen	Ovary	Uterus	Vagina	Cervix	Vulva	Clitoris	Penis	Scrotum	Testis	Prostate	Bladder	Ureter	Urethra	Rectum	Sigmoid	Colon	Small	Large	Appendix	Gallbladder	Pancreas	Spleen	Lungs	Heart	Aorta	Ventricle	Artery	Vein	Nerve	Muscle	Bone	Joint	Skin	Hair	Nails	Sweat	Tears	Saliva	Urine	Feces	Semen	Ovary	Uterus	Vagina	Cervix	Vulva	Clitoris	Penis	Scrotum	Testis	Prostate	Bladder	Ureter	Urethra	Rectum	Sigmoid	Colon	Small	Large	Appendix	Gallbladder	Pancreas	Spleen	Lungs	Heart	Aorta	Ventricle	Artery	Vein	Nerve	Muscle	Bone	Joint	Skin	Hair	Nails	Sweat	Tears	Saliva	Urine	Feces	Semen	Ovary	Uterus	Vagina	Cervix	Vulva	Clitoris	Penis	Scrotum	Testis	Prostate	Bladder	Ureter	Urethra	Rectum	Sigmoid	Colon	Small	Large	Appendix	Gallbladder	Pancreas	Spleen	Lungs	Heart	Aorta	Ventricle	Artery	Vein	Nerve	Muscle	Bone	Joint	Skin	Hair	Nails	Sweat	Tears	Saliva	Urine	Feces	Semen	Ovary	Uterus	Vagina	Cervix	Vulva	Clitoris	Penis	Scrotum	Testis	Prostate	Bladder	Ureter	Urethra	Rectum	Sigmoid	Colon	Small	Large	Appendix	Gallbladder	Pancreas	Spleen	Lungs	Heart	Aorta	Ventricle	Artery	Vein	Nerve	Muscle	Bone	Joint	Skin	Hair	Nails	Sweat	Tears	Saliva	Urine	Feces	Semen	Ovary	Uterus	Vagina	Cervix	Vulva	Clitoris	Penis	Scrotum	Testis	Prostate	Bladder	Ureter	Urethra	Rectum	Sigmoid	Colon	Small	Large	Appendix	Gallbladder	Pancreas	Spleen	Lungs	Heart	Aorta	Ventricle	Artery	Vein	Nerve	Muscle	Bone	Joint	Skin	Hair	Nails	Sweat	Tears	Saliva	Urine	Feces	Semen	Ovary	Uterus	Vagina	Cervix	Vulva	Clitoris	Penis	Scrotum	Testis	Prostate	Bladder	Ureter	Urethra	Rectum	Sigmoid	Colon	Small	Large	Appendix	Gallbladder	Pancreas	Spleen	Lungs	Heart	Aorta	Ventricle	Artery	Vein	Nerve	Muscle	Bone	Joint	Skin	Hair	Nails	Sweat	Tears	Saliva	Urine	Feces	Semen	Ovary	Uterus	Vagina	Cervix	Vulva	Clitoris	Penis	Scrotum	Testis	Prostate	Bladder	Ureter	Urethra	Rectum	Sigmoid	Colon	Small	Large	Appendix	Gallbladder	Pancreas	Spleen	Lungs	Heart	Aorta	Ventricle	Artery	Vein	Nerve	Muscle	Bone	Joint	Skin	Hair	Nails	Sweat	Tears	Saliva	Urine	Feces	Semen	Ovary	Uterus	Vagina	Cervix	Vulva	Clitoris	Penis	Scrotum	Testis	Prostate	Bladder	Ureter	Urethra	Rectum	Sigmoid	Colon	Small	Large	Appendix	Gallbladder	Pancreas	Spleen	Lungs	Heart	Aorta	Ventricle	Artery	Vein	Nerve	Muscle	Bone	Joint	Skin	Hair	Nails	Sweat	Tears	Saliva	Urine	Feces	Semen	Ovary	Uterus	Vagina	Cervix	Vulva	Clitoris	Penis	Scrotum	Testis	Prostate	Bladder	Ureter	Urethra	Rectum	Sigmoid	Colon	Small	Large	Appendix	Gallbladder	Pancreas	Spleen	Lungs	Heart	Aorta	Ventricle	Artery	Vein	Nerve	Muscle	Bone	Joint	Skin	Hair	Nails	Sweat	Tears	Saliva	Urine	Feces	Semen	Ovary	Uterus	Vagina	Cervix	Vulva	Clitoris	Penis	Scrotum	Testis	Prostate	Bladder	Ureter	Urethra	Rectum	Sigmoid	Colon	Small	Large	Appendix	Gallbladder	Pancreas	Spleen	Lungs	Heart	Aorta	Ventricle	Artery	Vein	Nerve	Muscle	Bone	Joint	Skin	Hair	Nails	Sweat	Tears	Saliva	Urine	Feces	Semen	Ovary	Uterus	Vagina	Cervix	Vulva	Clitoris	Penis	Scrotum	Testis	Prostate	Bladder	Ureter	Urethra	Rectum	Sigmoid	Colon	Small	Large	Appendix	Gallbladder	Pancreas	Spleen	Lungs	Heart	Aorta	Ventricle	Artery	Vein	Nerve	Muscle	Bone	Joint	Skin	Hair	Nails	Sweat	Tears	Saliva	Urine	Feces	Semen	Ovary	Uterus	Vagina	Cervix	Vulva	Clitoris	Penis	Scrotum	Testis	Prostate	Bladder	Ureter	Urethra	Rectum	Sigmoid	Colon	Small	Large	Appendix	Gallbladder	Pancreas	Spleen	Lungs	Heart	Aorta	Ventricle	Artery	Vein	Nerve	Muscle	Bone	Joint	Skin	Hair	Nails	Sweat	Tears	Saliva	Urine	Feces	Semen	Ovary	Uterus	Vagina	Cervix	Vulva	Clitoris	Penis	Scrotum	Testis	Prostate	Bladder	Ureter	Urethra	Rectum	Sigmoid	Colon	Small	Large	Appendix	Gallbladder	Pancreas	Spleen	Lungs	Heart	Aorta	Ventricle	Artery	Vein	Nerve	Muscle	Bone	Joint	Skin	Hair	Nails	Sweat	Tears	Saliva	Urine	Feces	Semen	Ovary	Uterus	Vagina	Cervix	Vulva	Clitoris	Penis	Scrotum	Testis	Prostate	Bladder	Ureter	Urethra	Rectum	Sigmoid	Colon	Small	Large	Appendix	Gallbladder	Pancreas	Spleen	Lungs	Heart	Aorta	Ventricle	Artery	Vein	Nerve	Muscle	Bone	Joint	Skin	Hair	Nails	Sweat	Tears	Saliva	Urine	Feces	Semen	Ovary	Uterus	Vagina	Cervix	Vulva	Clitoris	Penis	Scrotum	Testis	Prostate	Bladder	Ureter	Urethra	Rectum	Sigmoid	Colon	Small	Large	Appendix	Gallbladder	Pancreas	Spleen	Lungs	Heart	Aorta	Ventricle	Artery	Vein	Nerve	Muscle	Bone	Joint	Skin	Hair	Nails	Sweat	Tears	Saliva	Urine	Feces	Semen	Ovary	Uterus	Vagina	Cervix	Vulva	Clitoris	Penis	Scrotum	Testis	Prostate	Bladder	Ureter	Urethra	Rectum	Sigmoid	Colon	Small	Large	Appendix	Gallbladder	Pancreas	Spleen	Lungs	Heart	Aorta	Ventricle	Artery	Vein	Nerve	Muscle	Bone	Joint	Skin	Hair	Nails	Sweat	Tears	Saliva	Urine	Feces	Semen	Ovary	Uterus	Vagina	Cervix	Vulva	Clitoris	Penis	Scrotum	Testis	Prostate	Bladder	Ureter	Urethra	Rectum	Sigmoid	Colon	Small	Large	Appendix	Gallbladder	Pancreas	Spleen	Lungs	Heart	Aorta	Ventricle	Artery	Vein	Nerve	Muscle	Bone	Joint	Skin	Hair	Nails	Sweat	Tears	Saliva	Urine	Feces	Semen	Ovary	Uterus	Vagina	Cervix	Vulva	Clitoris	Penis	Scrotum	Testis	Prostate	Bladder	Ureter	Urethra	Rectum	Sigmoid	Colon	Small	Large	Appendix	Gallbladder	Pancreas	Spleen	Lungs	Heart	Aorta	Ventricle	Artery	Vein	Nerve	Muscle	Bone	Joint	Skin	Hair	Nails	Sweat	Tears	Saliva	Urine	Feces	Semen	Ovary	Uterus	Vagina	Cervix	Vulva	Clitoris	Penis	Scrotum	Testis	Prostate	Bladder	Ureter	Urethra	Rectum	Sigmoid	Colon	Small	Large	Appendix	Gallbladder	Pancreas	Spleen	Lungs	Heart	Aorta	Ventricle	Artery	Vein	Nerve	Muscle	Bone	Joint	Skin	Hair	Nails	Sweat	Tears	Saliva	Urine	Feces	Semen	Ovary	Uterus	Vagina	Cervix	Vulva	Clitoris	Penis	Scrotum	Testis	Prostate	Bladder	Ureter	Urethra	Rectum	Sigmoid	Colon	Small	Large	Appendix	Gallbladder	Pancreas	Spleen	Lungs	Heart	Aorta	Ventricle	Artery	Vein	Nerve	Muscle	Bone	Joint	Skin	Hair	Nails	Sweat	Tears	Saliva	Urine	Feces	Semen	Ovary	Uterus	Vagina	Cervix	Vulva	Clitoris	Penis	Scrotum	Testis	Prostate	Bladder	Ureter	Urethra	Rectum	Sigmoid	Colon	Small	Large	Appendix	Gallbladder	Pancreas	Spleen	Lungs	Heart	Aorta	Ventricle	Artery	Vein	Nerve	Muscle	Bone	Joint	Skin	Hair	Nails	Sweat	Tears	Saliva	Urine	Feces	Semen	Ovary	Uterus	Vagina	Cervix	Vulva	Clitoris	Penis	Scrotum	Testis	Prostate	Bladder	Ureter	Urethra	Rectum	Sigmoid	Colon	Small	Large	Appendix	Gallbladder	Pancreas	Spleen	Lungs	Heart	Aorta	Ventricle	Artery	Vein	Nerve	Muscle	Bone	Joint	Skin	Hair	Nails	Sweat	Tears	Saliva	Urine	Feces	Semen	Ovary	Uterus	Vagina	Cervix	Vulva	Clitoris

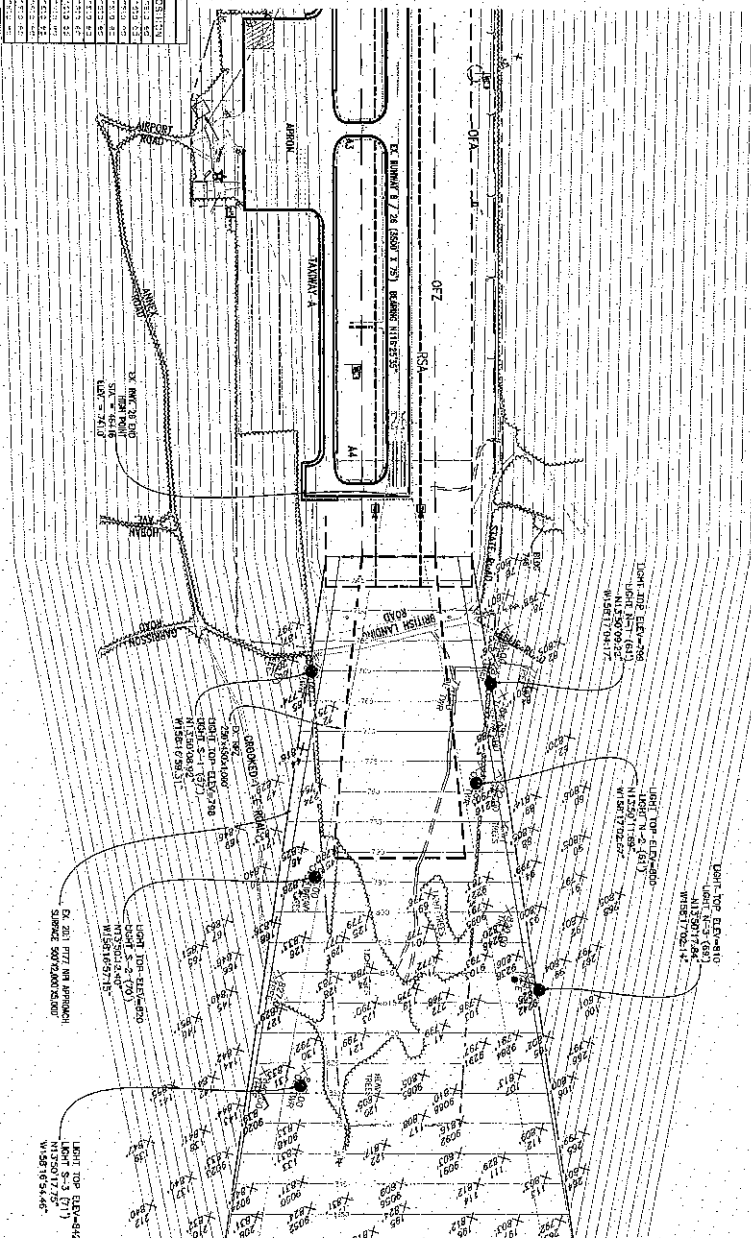
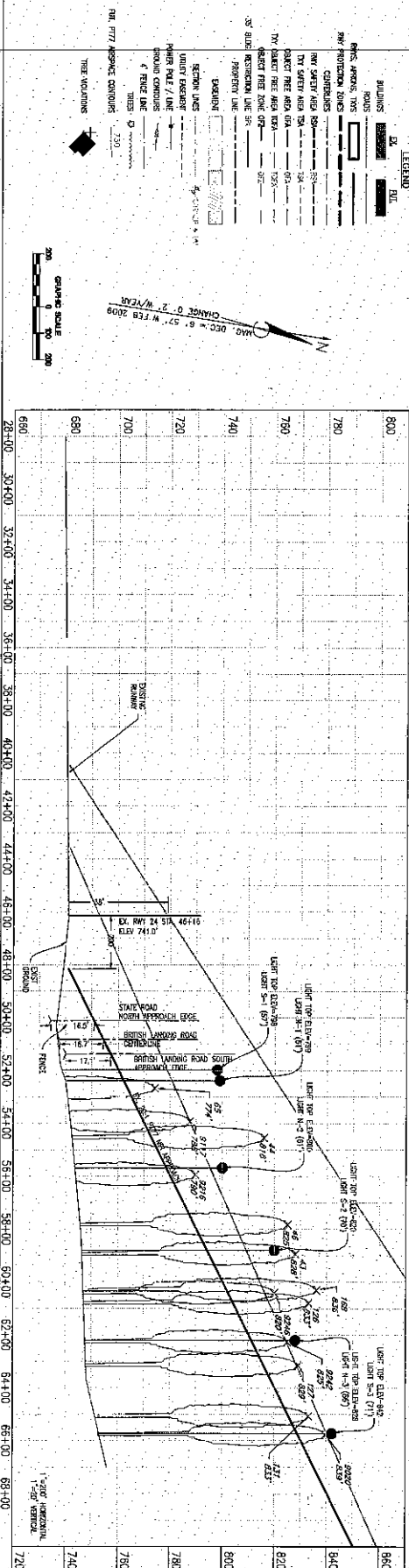

MACKINAC ISLAND AIRPORT

AIRPORT LAYOUT PLAN

MACKINAC ISLAND, MICHIGAN



GRAND RAPIDS, MI
3650 SPARKS DR. S.E.
318 574-8500

D/E JW	X		
PM RJC	X		
SOC DR	X		
QC RJC	X		
W. MALINOWSKI		06-26-85	AS BUILT C&S SEE BUILDING EXPANSION
IN CHARGE		05-03-84	AS CONSTRUCTED 41 GOLF, REMOVAL
		06-01-82	AS CONSTRUCTED C&S P&T 4/26 REMOVAL
		10-08-80	APPROVED PLUS
		DATE	ISSUED FOR



CHANGE 0.2 W/YEAR
FEB 2009

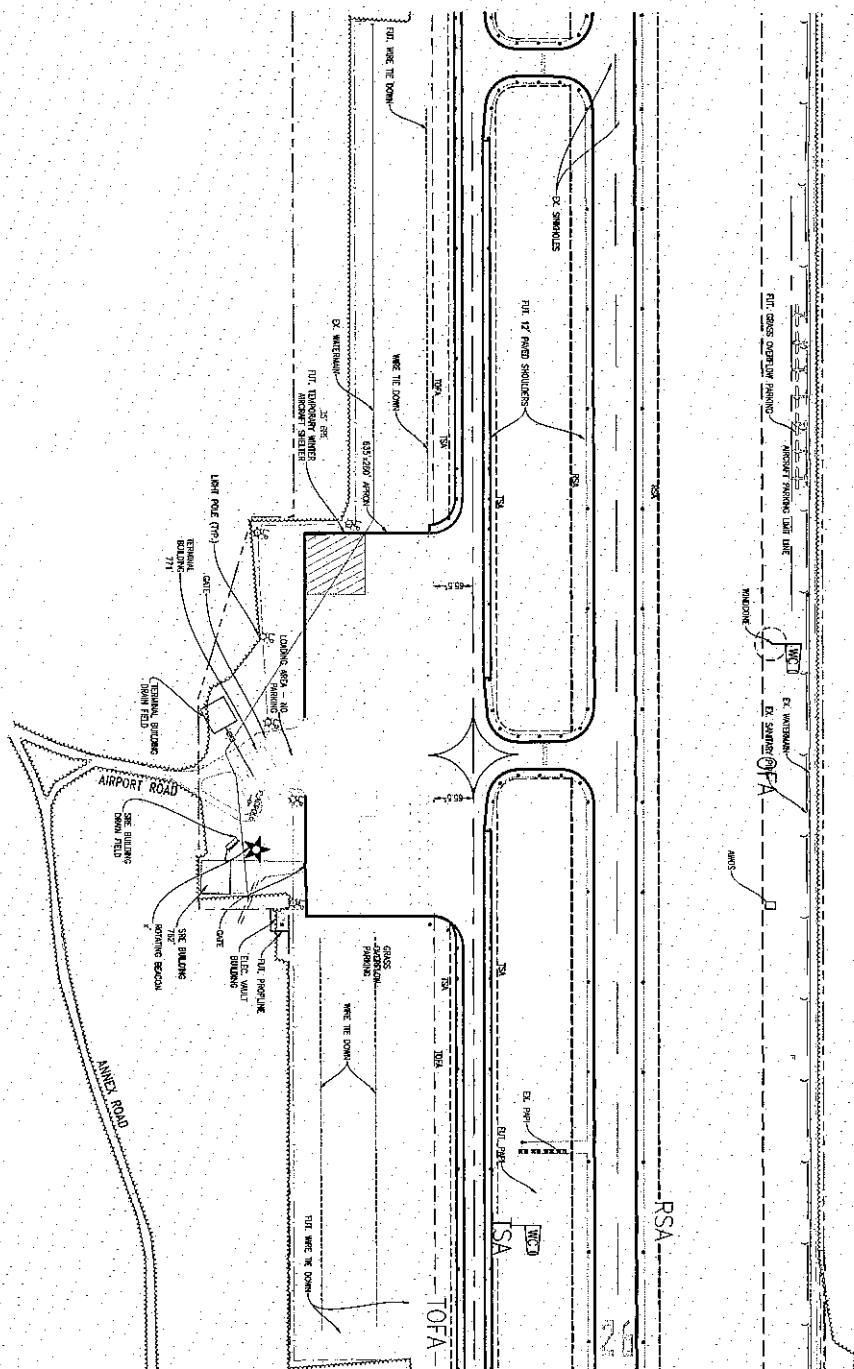

12940245

DRAWING
8 OF 10

MICHIGAN SITE NO.	49-6
FAA ID	MCD

MACKINAC ISLAND AIRPORT

AIRPORT LAYOUT PLAN

TERMINAL AREA PLAN

MACKINAC ISLAND, MICHIGAN

URS

GRAND RAPIDS, MI.
3930 SPRUCE DR. S.E.
518 574-8500

D/E NW	X		
RM - RJG	X		
SOC DR	X		
QC - RJG	X		
W. MALINOWSKI		08-28-18	AS BUILT CUL SEE BUILDING DEVISION
		05-03-14	AS CONSTRUCTED 41 DIST. REMOVAL
		05-01-12	AS CONSTRUCTED C34 RHY 8/26 REMOVAL
		12-08-08	APPROVED PLAN
IN CHARGE		DATE	ISSUED FOR

[illegible]

...IMPOSED BY AN ACT OF CONGRESS, STATE RECEIVED IT BY ACT 1960(H) OF 1984, AND AMENDED ACT 201 OF PUBLIC ACTS OF 1988
PARCEL D AT MEALAD GOO'S CONFIRMATION OF THE VAGRANTY YEED SHALL UNQUOTE BE RECORDED BY MACANONG ISLAND DEVELOPMENT COMMISSION
*** EASEMENTS CLEAR A LOT WERE ORIGINALLY SCHEDULED TO BE ACQUIRED AS PART OF B-28-0059-997, BUT WERE ABANDONED AFTER
IT BECAME CLEAR THAT THE 2012 RUMWY RECONSTRUCTION PROJECT WOULD SHIFT THE RUNWAY EAST AND THE RUNWAY PROTECTION ZONE
NO LONGER IMPACTED THESE PARCELS.

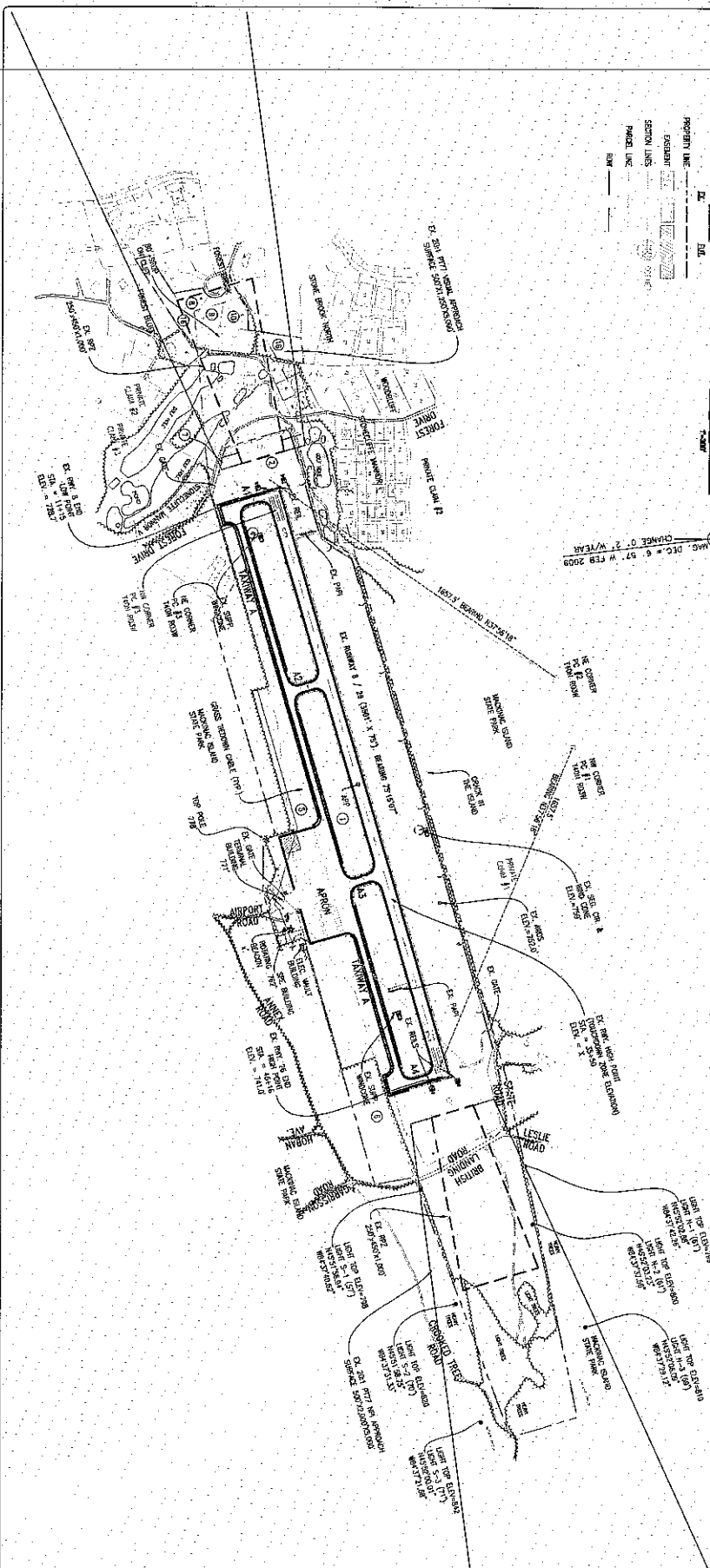
Total Essential Amino Acids = ± 12.6 

12940245	DRAWING 9 OF 10	MICHIGAN SITE NO. 49-6	MACKINAC ISLAND AIRPORT
		FSA ID MCD	AIRPORT LAYOUT PLAN AIRPORT PROPERTY PLAN
		MACKINAC ISLAND, MICHIGAN	



GRAND RAPIDS, MI. 3650 SPRING DR. S.E. 616 274-4554	D/E JY		
	PM RAC		
	SQC DR		
	QC R/C		
	K. MALING/SS		
IN CHARGE	DATE	ISSUED FOR	
	08-28-15	RE BUILT GAS SHE BUILDING DIVISION	
	05-05-14	AS CONSTRUCTED 40 DIST. REGIONAL	
	08-01-12	AS CONSTRUCTED GAS WNT 5/25 1994	
	10-08-09	UPHOLD PLAN	

Appendix D

Stakeholder Interviews Results

Stakeholder Interviews

Interview #01

1. Are you familiar with the Master Planning process, and do you know the purpose of a Master Plan?

Yes, familiar with master planning as part of a campus master planning effort in Indiana.

2. Are you familiar with, or have you had any experience with the Mackinac Island Master Plan? If so, please describe.

Read the document. It is general in nature.

3. In your opinion, what are the most important planning and/or development issues facing Mackinac Island today or in the next 5 to 10 years?

Affordable housing, sewer capacity, and adequacy of infrastructure.

Affordable housing issue – service industry needs to live someplace. Develop the public areas which are available for affordable housing. If the affordable housing is taken care of, then it helps balance the need for developments elsewhere.

What is the capacity of the sewer plant? The City does not exactly know how much capacity the sewer plant has. We absolutely need to know the capacity for the City to be able to plan for the future.

Concerned about a proposed 242-person employee housing project proposed on the island that would use a septic system. What are the environmental concerns about using a septic system where the waste would eventually drain to the Lake?

Businesses would love to move employee housing from downtown to other (cheaper) areas to allow for the downtown sites to develop for new businesses/hotels/etc. This just creates a cycle of the need for more employee housing. Need to understand the consequences of today's decisions and how they impact future decisions.

15 years from now, if we have 1 million visitors, do we have sufficient infrastructure to support it?

Would like to see the island stay like it is forever, but understands that there needs to be a balance for development.

4. How can Mackinac Island best address the key issues you have identified?

There needs to be a review of the status of existing infrastructure. In order to figure this out, we need a plan to study the adequacy of the City's existing infrastructure systems.

Develop the public areas/city lands which are available for affordable housing. This would allow for the service industry to live here (school teachers, police, etc.).

5. Are there any new planning and/or zoning tools and techniques that should be considered by the City which can address the key issues you have identified?

Would like to have a study which evaluates the development potential of certain areas of the City given the current zoning designations and density allowances.

The City should look at the potential of purchasing property and putting in it a protected status.

6. Is there anything else you would like to share related to the future of Mackinac Island?

The City needs to make sure that the characteristics which make the island a cherished place (ambiance, keeping it "Mackinac", historic districts) are not lost.

Stakeholder Interviews

Interview #02

1. Are you familiar with the Master Planning process, and do you know the purpose of a Master Plan?

Somewhat familiar with master planning.

2. Are you familiar with, or have you had any experience with the Mackinac Island Master Plan? If so, please describe.

No.

3. In your opinion, what are the most important planning and/or development issues facing Mackinac Island today or in the next 5 to 10 years?

City has changed and is changing, and the change is not always for the better. Hopes that the City is able to maintain the current historic character of the downtown district. Does not want to see allowance for taller buildings downtown (taller than what is currently built).

Concerned that development is overtaking the island. This concern is most relevant to the historic downtown portion of the island, but generally all over the island.

Employee housing is a key issue facing the City. Doesn't feel that the City needs more employee housing, particularly within the Harrisonville area. Employee housing could be appropriate in other locations outside of established residential areas and/or where there is more of a buffer between residential homes.

Another concern is the increasing development pressure given the limitations of the island's water/waste treatment facility.

Lack of affordable housing was also mentioned as a concern .

4. How can Mackinac Island best address the key issues you have identified?

The City should maintain the downtown district as it is.

The City should consider directing employee housing to more appropriate areas outside of established residential areas and/or where there is more of a buffer between residential homes.

- 5. Are there any new planning and/or zoning tools and techniques that should be considered by the City which can address the key issues you have identified?**

Not offhand.

- 6. Is there anything else you would like to share related to the future of Mackinac Island?**

Hope the City maintains its small island feel and existing character. Don't let it get out of hand before it is too late.

Stakeholder Interviews

Interview #03

1. Are you familiar with the Master Planning process, and do you know the purpose of a Master Plan?

Somewhat familiar.

2. Are you familiar with, or have you had any experience with the Mackinac Island Master Plan? If so, please describe.

Yes, is familiar with the Plan's emphasis on historical preservation.

3. In your opinion, what are the most important planning and/or development issues facing Mackinac Island today or in the next 5 to 10 years?

One major concern is that the natural environment/beauty/character of the island is in jeopardy. Concerned that City leaders are not emphasizing the need for protecting the natural environment.

Shore line change is a concern. Sees more algae in the water. Would like to see the City address this.

Horse waste and its impact on the natural environment is a concern. Doesn't feel that enough attention is being paid to this issue. Composting system is a good program, but more needs to be done.

Other main concern is that the historic character of the island is in jeopardy. Would like to see the historic and Victorian character of the island preserved. This is what people come to the island to see. Concerned that development pressure and over-development will work against the historic character.

Housing – Used to be lots of apartments to rent for full-time and part-time residents. Now most businesses have bought up and rent all of these apartments for employees. There is limited apartment type housing for people who want to have a decent place to live.

Affordable housing – City should designate certain areas where affordable housing could be developed. So much of the existing supply of affordable housing is being bought at a high price by businesses. Young persons who have grown up on the island and want to stay are having trouble finding a decent/affordable place to live.

4. How can Mackinac Island best address the key issues you have identified?

The City should purchase land to be set aside for affordable housing.

Would like the City to hire an environmental consultant to come in and evaluate the health of the environment and come up with recommendations to improve/protect. Education and emphasis on environmental protection should be at the forefront. Consider current practices regarding the application of fertilizer. We need to be more environmentally aware.

5. Are there any new planning and/or zoning tools and techniques that should be considered by the City which can address the key issues you have identified?

Zone certain areas where affordable housing is allowed, and where businesses can't come in and buy it up and turn it into non-affordable housing.

We have reached our capacity for housing employees in the City.

6. Is there anything else you would like to share related to the future of Mackinac Island?

Water/sewer plant – We don't have a firm grip on how much capacity it can handle. Lots of lots are left to be developed, and the city needs to have a better understanding. What happens once we reach that capacity? Also concerned about the use of septic tanks – doesn't want to see development that uses septic tanks which could harm the natural environment.

Stakeholder Interviews

Interview #04

- 1. Are you familiar with the Master Planning process, and do you know the purpose of a Master Plan?**

Yes, generally familiar, but not deeply involved.

- 2. Are you familiar with, or have you had any experience with the Mackinac Island Master Plan? If so, please describe.**

Has seen certain pages/maps but not particular experience.

- 3. In your opinion, what are the most important planning and/or development issues facing Mackinac Island today or in the next 5 to 10 years?**

State owns 80% of island – this is a great thing. This is a great green buffer.

Downtown is seen as commercial, and within reason, should be able to be developed.

We are a resort area, which includes the golf and hotels. Development within reason. The one change which has happened in the past 5 years is the ferry boat situation. There arguably is a need for a public access to freight and winter passage. Winter passage is very important.

Harrisonville – combination of single-family residences and employee housing should continue. We had affordable housing initiative years ago.

- 4. How can Mackinac Island best address the key issues you have identified?**

The biggest concern is the dock and how we address this. Consider a public-owned facility.

- 5. Are there any new planning and/or zoning tools and techniques that should be considered by the City which can address the key issues you have identified?**

Not particularly.

- 6. Is there anything else you would like to share related to the future of Mackinac Island?**

Not particularly.

Stakeholder Interviews

Interview #05

1. Are you familiar with the Master Planning process, and do you know the purpose of a Master Plan?

Been on City Council for many years. Was on Council when the master plan was first written.

2. Are you familiar with, or have you had any experience with the Mackinac Island Master Plan? If so, please describe.

Not familiar with the current Master Plan.

3. In your opinion, what are the most important planning and/or development issues facing Mackinac Island today or in the next 5 to 10 years?

We need a good economic base – keeping people working. Need limited, controlled growth. At the same time, need to maintain a year round viable community. Being able to live here affordably is very important.

Having good housing for employees is important. Local businesses started buying properties in Harrisonville for housing. It has changed the nature of Harrisonville to multi-use housing types.

The City should help out more with providing affordable housing. The City should seek to develop public property for housing development (service industry). An example is the Post Office, which is a 1 story building -- the City should consider building apartments above to house the service industry.

Need limited, controlled growth. Can't allow growth to overwhelm existing infrastructure capacities, without a long-term plan.

Any growth which is going to happen needs to coordinate with existing infrastructure. Infrastructure must be there to support it.

Businesses here help to keep the tax base strong and the millage low.

4. How can Mackinac Island best address the key issues you have identified?

Support the concept of a Housing Authority to help allow for financing for housing, as appropriate. Gives the City a working tool which it hasn't had before.

In general, the long term planning for housing and the need for it should be addressed. There may be the ability to provide additional space (to the west?) in the Harrisonville area, owned by the State, but should be made into a lease situation, for single-family homes. Available to residents only... not employees. For painters, plumbers, refrigeration guys. 100+ people get off the boat every day who are in the service industry.

Important to keep the service facilities going – school, medical center, etc.

5. Are there any new planning and/or zoning tools and techniques that should be considered by the City which can address the key issues you have identified?

Nothing in particular.

6. Is there anything else you would like to share related to the future of Mackinac Island?

Well thought out and planned out development is important. Growth is important. But we can't lose sight of the need to keep a year-round viable community.

The DPW is in the middle of doing an assessment of infrastructure. Any planning which goes on needs to be considered in this Master Plan. The Water/Sewer Planning effort is currently underway (FTCH out G.R.). We need to understand the bigger picture of what is do-able in terms of future infrastructure and costs.

Stakeholder Interviews

Interview #06

- 1. Are you familiar with the Master Planning process, and do you know the purpose of a Master Plan?**

Yes.

- 2. Are you familiar with, or have you had any experience with the Mackinac Island Master Plan? If so, please describe.**

Yes.

- 3. In your opinion, what are the most important planning and/or development issues facing Mackinac Island today or in the next 5 to 10 years?**

All for business, but I think we cannot lose the historic nature or the historic background of Mackinac. That's why the Historic District Commission is very important... to keep our special atmosphere of Mackinac Island. It's not just any other place... when they get off the boat, they step back in time. We need to maintain that kind of a character. Even though we have to be progressive.

Trying to figure out housing in order to maintain year-round housing/residents. So much of our housing is for employees. Not having year-round housing would affect school, and service industries.

The horse history brings a special character. It is important to maintain the horse business/trade.

Traffic control and traffic safety (pedestrians/horses/bicycles).

Our medical center is very important to the community. Without it, we cannot have businesses. It is the most important building on the island.

Our transportation issue – we are working to solve both the summer transportation and the winter transportation. Both ferry and air. Hear rumors of a ferry service being sold – need to keep it maintained and maintain a winter boat service for the island. Air transportation is so important for medivacs and for when the ferry isn't operating.

- 4. How can Mackinac Island best address the key issues you have identified?**

Can only be done by working together. Need to establish committees that work together with businesses.

Housing – need to work with the businesses and/or the State Historic Park to see about getting land to potentially build housing.

5. Are there any new planning and/or zoning tools and techniques that should be considered by the City which can address the key issues you have identified?

Need to keep sharing with similar communities (Mackinac City / Beaver Island). Also keep in touch with MML.

6. Is there anything else you would like to share related to the future of Mackinac Island?

Mackinac Island is such a special place – the Gem of Michigan. We are the caretakers of it, and it is our responsibility to maintain the beauty, historic nature, and special ambiance of Mackinac. Not only to encourage people to continue to come here, but also for the residents that live here on a year-round basis.

Stakeholder Interviews

Interview #07

1. Are you familiar with the Master Planning process, and do you know the purpose of a Master Plan?

Yes.

2. Are you familiar with, or have you had any experience with the Mackinac Island Master Plan? If so, please describe.

Read the current Master Plan and has looked at the map. Was on the historic district commission for a year around the time the last plan was prepared.

3. In your opinion, what are the most important planning and/or development issues facing Mackinac Island today or in the next 5 to 10 years?

Same issue has been going on for some time – overdevelopment. Thank God that the state park owns 80% of the island or it would entirely be developed. The spaces not owned by the state are being developed to their absolute maximum. Need to recalculate the REU's for the sewer system – seems like all that was going to do was to allow for more development in areas which are already over-stressed. Understanding of the desire to fully develop a property, but open space needs to be considered. This also could have an impact on city services, which are currently pretty good.

Also concerned about how faithfully the City will adhere to a new Master Plan. There were some changes/variations from the Master Plan related to the Silver Birches project. Needs to be a stronger adherence to the Master Plan.

Access to the island through the dock system is a concern. My understanding is that the City has jurisdiction over harbor works. Waterways commission claims to have jurisdiction. Concerned about interruption of service if one of the existing docks was developed for a different purpose. Access to the island, including for freight, is very important.

Another concern is congestion – bicycle traffic, etc.

Want to make sure that citizens and property owners have the opportunity to share their thoughts while the Master Plan is being developed.

4. How can Mackinac Island best address the key issues you have identified?

REU question is a major one. Don't fully understand how available REU's are calculated. Not sure if final decision or analysis has occurred. Clear that the system/waste disposal system needs some work/improvement. City needs to be careful in making any allowance for additional REU's.

5. Are there any new planning and/or zoning tools and techniques that should be considered by the City which can address the key issues you have identified?

More adherence to the adopted Master Plan.

Does not want to see overdevelopment of the north area of the island.

6. Is there anything else you would like to share related to the future of Mackinac Island?

Despite the overdevelopment, the City is a beautiful place and historic place. Change needs to be managed and be directed by the Master Plan. It is worth the effort to keep the place as historical, quaint and interesting as it always has been.

The City should focus on historic preservation and should address it in the Master Plan. The City should be careful of allowing changes to buildings out of character with the historic area. These changes may jeopardize the historic district designation status.

Affordable housing – There is a lack of affordable housing. The old community (Irish/French/native American) is withering away. The year round community may not be viable moving forward due to the lack of affordable housing.

Stakeholder Interviews

Interview #08

1. Are you familiar with the Master Planning process, and do you know the purpose of a Master Plan?

Yes, it is a long-term plan for development.

2. Are you familiar with, or have you had any experience with the Mackinac Island Master Plan? If so, please describe.

Somewhat familiar.

3. In your opinion, what are the most important planning and/or development issues facing Mackinac Island today or in the next 5 to 10 years?

Taking care of our guests and tourists to Mackinac Island. Make our guests happy with their experience.

Maintain the natural beauty of the island. Not just landscaped well, but also keeping it very clean.

Preserve the history of Mackinac Island. Keep that on the forefront of our guest's minds.

Need to be cognizant of those that are staying overnight. There is a balance between buildings which are in poor condition and should be demolished, but may be forced to be preserved. It may be historic, but they are unsafe. Need safe buildings up to code for the protection of citizens and tourists. New buildings built need to be consistent with the historic character.

We need density on Mackinac Island. The sewer capacity was improved recently, which is good and should allow for more density (development). We need density so people stay on the island, enjoy the island, and spend money on the island.

Growth does need to be controlled, but there is a big difference between good development and bad development. Good development should be allowed.

Do believe in preserving as much open space as possible, including within Downtown. Need to maintain Windermere point.

People have a right to develop their private property.

Employee housing is important to maintain.

Three story buildings downtown is plenty. Don't lower maximum height limit to two stories.

Year-round community is important to maintain, and to increase it over time.

Horse culture and bike culture is important to maintain.

4. How can Mackinac Island best address the key issues you have identified?

City has done a good job overall of addressing these issues. Should keep in mind that the tourism industry is what is paying the bills. The tourist season is short-term; the island is pretty quiet most of the time. Don't downzone. Just make sure that new development is done properly. City should always engage the business community in important decisions.

5. Are there any new planning and/or zoning tools and techniques that should be considered by the City which can address the key issues you have identified?

In favor of millage going up to preserve open space and buy development rights.

Favors upgrades to the sewer system.

6. Is there anything else you would like to share related to the future of Mackinac Island?

Nothing noted.

Stakeholder Interviews

Interview #09

1. Are you familiar with the Master Planning process, and do you know the purpose of a Master Plan?

Pretty familiar with the Master Plan. Used to work for the City as a dispatcher and traffic safety officer. Has some experience with GIS and generally understands urban planning.

2. Are you familiar with, or have you had any experience with the Mackinac Island Master Plan? If so, please describe.

Not really familiar with the current Master Plan.

3. In your opinion, what are the most important planning and/or development issues facing Mackinac Island today or in the next 5 to 10 years?

Residential homes are disappearing at an alarming rate. Citizens are being forced to leave the island. Cost of living is very high. Unfortunately, wages have remained stagnant. Jobs have become devalued and are making less than 20-30 years ago. High taxes. High property values, lots of seasonal employment but not much year round work. If residents are lucky enough to own a home, they are often selling to the highest bidder. Then, it is usually sold to a business and it is turned into employee housing. It is much cheaper for businesses to purchase an existing home and turn it into employee housing as opposed to developing vacant land from scratch.

City and State Park relationship. Majority of land is owned by the State, and the State is not going to open it up for sale. If the State would open up land for development, it would be nice to see year round citizens to have the first opportunity at it. It would be nice to see single-family dwellings developed.

Our waste water plant is a concern. It is an aging facility and there is not necessarily the money available to bring it up to speed.

4. How can Mackinac Island best address the key issues you have identified?

City should seek to work with financial institutions to see what kind of financing options/programs might be available for loans for home purchasing. Cost of entry for housing is too high and lack of housing availability. City could consider developing affordable housing which is restricted to year round residents.

Our wastewater collection system is obsolete. The plant was given a partial upgrade in 2012/2013 which helped. But it didn't address our collection system. The plant has a little more capacity with the upgrade, but getting the wastewater to the plant is posing a challenge. FTC&H engineering firm has been working on a study for a lift station. A bigger issue is one key lift station which is struggling to keep up with demand during the summer.

5. Are there any new planning and/or zoning tools and techniques that should be considered by the City which can address the key issues you have identified?

City may finally be getting a new GIS database going for the utility system. This is a great project, but good data needs to go into it.

Should there be a place of refuge (facility) which would serve as an emergency shelter during an emergency?

6. Is there anything else you would like to share related to the future of Mackinac Island?

I hope we can iron out our differences and get the community more involved in local politics. Let's get people rallied and interested and take responsibility for solving the City's challenges.

Stakeholder Interviews

Interview #10

- 1. Are you familiar with the Master Planning process, and do you know the purpose of a Master Plan?**

Reasonably familiar.

- 2. Are you familiar with, or have you had any experience with the Mackinac Island Master Plan? If so, please describe.**

I have read and do have a copy of it.

- 3. In your opinion, what are the most important planning and/or development issues facing Mackinac Island today or in the next 5 to 10 years?**

From our perspective, we support limited further development on the island, both residentially and commercially. The biggest challenge is the City's ability to support that development in terms of infrastructure. For the island to be sustainable and viable, the infrastructure needs to be in place to support it. Managed land development is a hallmark of sustainable healthy communities.

Affordable housing is a very serious issue for many people. Hundreds of employees of the business need access to housing. It is hard to get people to work here without some form of affordable housing. The business assists in finding housing for their employees. It is a challenge. Other small independent businesses find it difficult.

- 4. How can Mackinac Island best address the key issues you have identified?**

Areas for further residential development should be considered, whether through State, private or City owned property. Or, perhaps higher density housing in more areas than is currently permitted.

The Harrison district provides some capacity for housing development, but much of that has been purchased by bigger businesses.

- 5. Are there any new planning and/or zoning tools and techniques that should be considered by the City which can address the key issues you have identified?**

Conditional rezoning is a useful tool – potentially as good and/or even better than the PUD tool. Both tools are very important in a community such as Mackinac Island.

One problem with the Future Land Use Map is that it feels somewhat like wishful thinking... it isn't necessarily practical in a historic/unique community such as Mackinac Island.

6. Is there anything else you would like to share related to the future of Mackinac Island?

Comments on the Future Land Use map:

- Mission Point Area – South of the Mission Point along the lakefront, there is a large swath of developable land which ought to be developed. We don't think that such a large chunk of private land should be designated for residential/open space only.
- Beaver Dock – This has been used as a commercial dock for 100 years. It is used as a freight dock. We believe that designating all of that as single family residential does not reflect its historic use and should not be its future use. Mackinac Island has limited docking capacity and it should remain as its current commercial use (it is legal non-conforming use).
- Mission Point Property – Future Land Use Map shows it as Hotel/Resort. The zoning is PUD. We think the PUD zoning is more important than the "Hotel/Resort" terminology as it is more than just Hotel/Resort. There are limited shops, etc.
- Silver Birches – Shown as Cottage Residential. The Future Land Use Map should be re-evaluated considering the recent Conditional Rezoning which would allow for a small resort hotel.

Stakeholder Interviews

Interview #11

1. Are you familiar with the Master Planning process, and do you know the purpose of a Master Plan?

Familiar with strategic planning processes, but not necessarily master planning.

2. Are you familiar with, or have you had any experience with the Mackinac Island Master Plan? If so, please describe.

Not very familiar with it.

3. In your opinion, what are the most important planning and/or development issues facing Mackinac Island today or in the next 5 to 10 years?

The challenge is how the City blends the pressure for development with the desire for preservation. Preservation includes not only the physical environment, but also the way of life, which is under threat based on the challenge for families to be able to afford to live here.

Another challenge – 15% of the island is City and 85% is Mackinac Island State Park. We interface and work cooperatively, but there are different priorities for the two.

- State Park priority is the protection of rich historic and natural resources
- State Park constituents are not just residents, but the residents of Michigan, USA and the world who are visitors. The State Park focus is on a much bigger audience.
- The State Park mission of protecting and preserving the historic and natural resources of the island is significant to how we approach issues:
 - It is difficult to give up land to the City, when the State Park is accountable to the State of Michigan and beyond
 - Carving up State park land for more housing is not the answer to the affordable housing issue. We should look for land on the mainland to provide affordable housing.

4. How can Mackinac Island best address the key issues you have identified?

We need to look toward the mainland to provide affordable housing to serve the needs of the island.

We need more strategic planning to move forward in a manner which allows development, but is not done at the expense of sacrificing what we cherish on the island.

The constant conversation between the City and State Park is very important. This communication helps us to be better prepared to face challenges together.

5. Are there any new planning and/or zoning tools and techniques that should be considered by the City which can address the key issues you have identified?

This is not an area that I am very familiar with. Open to any tools in use by other progressive communities that face the challenge of balancing development and preservation. Was in support of the recent creation of the historic districts on the island.

6. Is there anything else you would like to share related to the future of Mackinac Island?

There needs to be a “vetting” of the draft master plan with representatives of the State Parks.

Stakeholder Interviews

Interview #12

- 1. Are you familiar with the Master Planning process, and do you know the purpose of a Master Plan?**

Yes, is familiar.

- 2. Are you familiar with, or have you had any experience with the Mackinac Island Master Plan? If so, please describe.**

Haven't read it cover to cover but am familiar with it.

- 3. In your opinion, what are the most important planning and/or development issues facing Mackinac Island today or in the next 5 to 10 years?**

Retaining our year-round community, which is a support structure for everything else going on here. Affordable housing is getting harder to come by and the school is lowering in enrollment.

From a zoning perspective, we haven't necessarily been following the Master Plan and what's in it. Too many exceptions to the rules. Which means that areas where it should be residential you may have mini-hotels. Or bed and breakfast establishments have turned into hotels.

From an infrastructure perspective, we have had an increase in tourism and we have not added parking, restrooms, etc. (State Park has done a better job of this). Not enough to provide for the day tourists. We also have traffic flow problems which need to be addressed or managed. We have increased some higher police presence but more instruction/direction for tourists is needed.

- 4. How can Mackinac Island best address the key issues you have identified?**

City has had committees to study the affordable housing issue and is starting that back up again. Affordable housing group does still have some land in the Trillium area and can try to develop that for affordable housing. City should seek to work with the community foundation to possibly get grants/loans for people to build.

Need to follow-through with the new Master Plan update.

Increased police presence and better education for visitors before they come to the island, so they know what to expect. There is a shift where Shepler's and Star Line are getting increased passengers, and they are both closer to each other in the same end of town, which adds to congestion. Use the coal dock for more of the freight?

5. Are there any new planning and/or zoning tools and techniques that should be considered by the City which can address the key issues you have identified?

City should make better use of electronic/digital files which may help with administration of the zoning.

6. Is there anything else you would like to share related to the future of Mackinac Island?

One thing for the City that would make it easier.... we have grown to the size where a City Manager staff person would be good. The City has a mayor, staff and volunteers, but a City like Mackinac Island needs to move forward to that next step and have a City Manager.

Appendix E

Student Survey Results

City of Mackinac Island
Master Plan Update
Student Survey Results

Question 1: What is Mackinac Island's greatest feature or asset?

4th, 5th, & 6th Grade Answers:

- Historical Nature
- Its history
- Bikes
- The State Park
- Fudge
- The Fort, Sugar Loaf, and Arch Rock
- Arch Rock
- The Fort, Arch Rock, Sugar Loaf, Fort homes
- Grand Hotel. It brings many different people here
- Grand Hotel

Middle School Answers:

- Grand Hotel
- Grand
- Grand Hotel
- The Grand
- Grand Hotel
- That there's no cars so there is less pollution than an average city
- The forest because of its wildlife
- I love that the Island has a lot of amazing rock formations. I think the rock formation is a great thing for the Island because it attracts a lot of tourists.
- Trees and nature
- No cars
- No cars. I don't really like automobile travel.
- Horses
- No cars
- Forest
- No cars

- That it's surrounded by water
- Fudge
- Horses everywhere
- No cars

High School Answers:

- The beauty, beautiful plants and animals and the water
- That automobiles have been banned for public use
- Its unique feeling, with no cars, the island gets a homey feeling to it. The island is very relaxing and its beautiful geographical features help out greatly in attracting tourists from all over the world.
- Famous hotels such as the Grand. Also, historical places like the forts and battle fields.
- The horses and the small community where everyone is supportive to the school and local businesses (not Starbucks, it should not be here).
- The preservation of historical attributes. The island holds a lot of historical buildings and locations that help explain some of Michigan's great history.
- All the stores that keep the money flowing. The money helps the school with events such as sports and educational events.
- The carriage tours, all the visitors love seeing horses for the first time. The different land marks, they have sentimental and historical value.
- Its history, the forts and Native Americans. Between history and its amazing views; it is what brings people to the island at least for the most part.
- Natural beauty to Mackinac Island's greatest feature. Star gazing on a clear night, watching the sunset from Sunset Rock, and standing at Ann's Tablet watching tourists and freighters go by should be on everyone's bucket list. It's about as "Pure Michigan" as you're going to get.
- The tourists. Without them we would not have that many jobs to do on the island. The activities that we do on the island bring many tourists to keep us busy.
- Sugar Loaf and Arch Rock. They are both great areas to see the view of Mackinac Island and relax.
- The education system because of our small classes, students have more one on one time with the teachers and have a better chance to succeed in college.

Question 2: What existing elements of the City are most important to preserve?

4th, 5th, & 6th Grade Answers:

- The historical ways without land new stuff every year
- No cars
- The history
- Fort Mackinac
- The parks and forest
- The Fort
- Doud's, School
- The land and Fort
- Fort Mackinac
- The Fort

Middle School Answers:

- Golf courses
- Grand
- Fudge Shops
- The old buildings
- The Fort
- Preserve the facts that no cars are allowed and to keep the wildlife looking as healthy as possible
- We must keep safe the natural environment
- Keep the trees protected so we have ox². Also, protect the rock formations because we get a lot of money from tourists and they come here to see the rocks and the history of no cars.
- Forests
- Trees and Arch Rock
- Forest and no cars
- Keep the downtown the same
- Arch Rock. Keep people safe that live here
- The forests by Stone Cliff and everywhere else, not cutting down trees
- The fort and caves and the crack in the island.
- Horses
- Keep the history alive

- Historical things because tourists and others come to see them
- Keep the city cleaner

High School Answers:

- Nature, such as Arch Rock, Sugar Loaf, and other natural attractions
- That most shops and utilities are located in one central area keep its original figure. Organizations like Starbucks should be removed because in the past, the island never had trademarked companies. However, original ideas like Lucky Bean and all of the fudge shops is what makes Mackinac Island the way it is.
- Fudge
- Fudge
- The old houses, the fort, the horses, and the lilacs, they make this place special.
- Environmental areas that benefit the island's diverse wildlife as well as historical lands which reflect upon the island's rich history.
- Some of the existing elements such as historical areas are what need to be preserved. These need to be preserved so that tourists will keep coming to the island to see the historical properties.
- The land marks, they need to be preserved. Plus, the island itself, there is a lot of littering around the island.
- Its historic architecture and appeal. The island is known for its history and the buildings have for the most part kept their historic architecture which is appealing to people coming to the island like tourists.
- Roads and the upkeep of downtown are the most important elements to preserve. Patching up pot holes, to me, was a waste of money. The way the bikes/horses travel over these roads, the roads will be back to "normal" soon. We need to have someone that will take the time to redo our roads the right way. Also, making sure landscape around downtown area should be of main concern.
- Marquette Park, the art museum, Fort Mackinac because all of them have to do with the history of Mackinac Island. If people would like to know how Mackinac Island became what is today, check these places out.
- All of it. I believe that everything should be kept up to its best ability. Having it clean and fresh makes it different from everywhere else.
- The horses. They give the island an authentic look and provide the people working at the barns and for the taxi service much needed jobs.

Question 3: **What are the top 3 reasons you love living here:**
(Circle not more than 3)

4th, 5th, & 6th Grade Answers:

Recreational activities – 3 votes

Weather – 1 vote

Island character – 2 votes

Friendly people – 1 vote

Location – 3 votes

Neighborhoods – 1 vote

Parks facilities – 4 votes

Natural features – 4 votes

Safety – 2 votes

Restaurants – 1 vote

Schools – 2 votes

Shopping – 2 votes

Other (fill in the blank) – Bikes (1 vote)

Other (fill in the blank) – State Park (1 vote)

Other (fill in the blank) – Winter (1 vote)

Other (fill in the blank) – Food (1 vote)

Middle School Answers:

Recreational activities – 4 votes

Weather – 1 vote

Island character – 1 vote

Friendly people – 3 votes

Location – 9 votes

Neighborhoods – 3 votes

Parks facilities – 1 vote

Natural features – 9 votes

Safety – 5 votes

Restaurants – 3 votes

Schools – 3 votes

Shopping – 3 votes

Other (fill in the blank) – Friends (2 votes)

Other (fill in the blank) – Freedom (1 vote)

Other (fill in the blank) – Weather (1 vote)

Other (fill in the blank) – Bikes (3 votes)

Other (fill in the blank) – Snowmobiles (2 votes)

Other (fill in the blank) – Horses (2 votes)

Other (fill in the blank) – Food (1 vote)

Other (fill in the blank) – Fudge (1 vote)

Other (fill in the blank) – Not many people live here (1 vote)

High School Answers:

Recreational activities – 6 votes

Weather – 2 votes

Island character – 4 votes

Friendly people – 2 votes

Location – 4 votes

Neighborhoods – 0 votes

Parks facilities – 3 votes

Natural features – 9 votes

Safety – 3 votes

Restaurants – 1 vote

Schools – 4 votes

Shopping – 0 votes

Question 4: What would make our City more exciting for visitors?

4th, 5th, & 6th Grade Answers:

- More public bathrooms
- More tours downtown
- Dock jumping tours
- On certain days have sales in stores
- Tours around the entire island
- If people could rent sail boats
- Subway, less fudge shops
- Rent sailboats
- Advertise natural features so people explore more
- McDonalds

Middle School Answers:

- Amusement Park
- Mopeds
- More outdoor things
- If we could ride golf carts every where
- More activities outdoors
- More entertainment would probably be exciting for tourists
- Visitors might like zip lines
- More things to do like: activities, pools, contest, search and find, bounce houses, movie theaters
- More fudge
- Visitors would like it if there were more things to do.
- More hotel activities
- Water Park
- A zoo
- More Island culture
- Zip line and more things to do near British Landing.
- A Pizza Hut
- Mores stores and a zoo

- Zoos and to start a business so people can go tubing
- Sail boats

High School Answers:

- More things to do rather than just walking around, like roller coasters or rides found at county fairs
- A real movie theatre and possibly a bowling alley
- Continue to have hands-on activities for tourists, places like Fort Mackinac and the Butterfly House are loved by tourists and adding more of those type places.
- Less hotels and more buildings with fun events such as a laser tag area or an area that is a mini fair.
- A better playground at Marquette Park would be great for kids. The current playset is half hidden and not very big. Little kids easily get bored and need more entertainment.
- Improving and encouraging transportation into Mackinac via airplane. Flying into the island is a fun experience and should be promoted just as much as the ferries. Flying will also give our visitors a larger perspective of our island. Partner with Great Lakes Air.
- The city is pretty exciting how it is. There is much to do on the island during the summer.
- Having less construction around, yes things need to be fixed, however visitors don't like seeing this.
- I don't know, you already got history and amazing views. When someone comes to the island they can tour the island by bike or carriage, then they can go to all the shops, finally they can go parasailing. There is already so much that makes the city exciting that I can't think of anything else you could do.
- Adding a public gym where tourists could pay by entrance fee. It would have everything a normal membership-based gym would have and wouldn't be available to anyone under 14. More and more people are becoming aware of how they need to treat their bodies, so why not profit from it.
- Knowing more about the island and what has become of it. How it became to be as it is today. The history is really extraordinary here and I think people if they actually know more about the island and the people that live on the island.

- It already is exciting for visitors.
- An improved beach area. At work, many tourists have asked me where the beach is and I just realized that we don't have a specific area where people can safely swim.

Question 5: **What would make our City more exciting for kids and teens?**

4th, 5th, & 6th Grade Answers:

- Water park
- More adventure and a place to hang out
- Kids – trampoline space / teens – teen hang out space
- Free Zip Line
- Get some funny shirts (clothing), game store
- If turtle park had equipment at use of all times for kids
- More parks
- Nothing more, teenage things
- More games at places
- McDonalds

Middle School Answers:

- Riding gas machined things
- Mopeds
- Free Wi-Fi everywhere
- Golf cars because the little kids wouldn't have to ride bikes
- Interesting activities
- More fishing and sports places and more time to be in the lake
- Maybe fun activities every hour
- Tech classes, toy stores, movie theaters, haunted houses, parks, chunky cheese
- Small water park
- If they could do what they want to do.
- Better internet service

- Video game center
- Movie theaters for kids and teens
- More kid foods to menus like pizza, chicken, hot dots, and hamburgers. Also some kid entertainment.
- More attractions like the Haunted Theater
- More pools
- More toy stores, more computers in the library
- More sports for kids to play
- A movie theater

High School Answers:

- More events such as rides or a movie theater with actual movies that have just come out.
- A real movie theatre and possibly a bowling alley
- The City is filled with many exciting things to do in a kid's point of view. Every area has activities to do for a child. However, we do need lights at the basketball courts so we can play later at night.
- Having a community center would be great, especially during the fall, winter, and spring. In all three seasons there is usually rough weather to hang outside and not all parents would let kids in their house. The community center would be a place always open to all public and just a place to hang out. There could be multiple events there, many game, both video and non-video games. The purpose is mainly to have a hang-out for people, preferably for teens.
- A public pool would be fun for kids. I know there is one at the Grand, but having one more accessible would be great since the lake isn't usually very warm.
- Creating some sort of areas where teens can hang out that's not too close to where elderly people wish to relax and where children scream. No, we don't want to look creepy hanging in the woods anymore.
- A better basketball court would have more kids want to come to the park and play basketball. Some of the kids that live on the island want this also because every night in the summer, we'll go out there and play basketball.
- My friends and I play at Turtle Park every day. We would like to have lights put around the basketball park so we could play later.

- Host little buy-in activities that are meant for that age level. Most kids and teens don't like touring and site seeing like their parents. Thus, by hosting little races and other activities they could buy into it would make kids and teens have more to do during their stay.
- Guided bike tours around the hidden gems of Mackinac would be great for older/kids/teens. There should also be an official babysitting service where anyone (w/ a background check) can sign up. Leave your # w/ the company and they'll call you with jobs. They could be a member of the tourism bureau and they could send all inquiries to the babysitting business.
- Getting more involved with sports or crafts (activities). Having a place to go and hang out with people. Making it a place to go back to and tell their friends about this place. Also, knowing about when an activity starts and where it is going to be.
- More teen friendly activities. A club or something for teens to hang out would help too.
- A movie theater. Everyone that I know has to go off island to watch movies because Mission Point only plays one movie once a week. Not only will it make money from all the locals, but also from the tourists during summer.

Question 6: If there was one thing which you could change about the City, what would it be?

4th, 5th, & 6th Grade Answers:

- Less people always shopping and more enjoying nature
- Not a thing
- Harley Davidson Store
- Cheaper prices
- A sign telling where tourist should walk
- Make sure tourist can ride a bike
- How things work around here
- Less tourists
- Cars

Middle School Answers:

- Ride golf carts
- Allow Mopeds

- Get rid of people
- Allowing some land of motorized vehicles
- Make it so a certain amount of people are allowed on the island at a time
- More places for local fishing
- We need to add more stores
- Better roads, chunky cheese
- No selling new property in the forest
- More boat docks
- A Fort Hill that could easily be climbed
- Nothing
- Tuttle Park
- Stop ruining land like cutting down trees and flattening land.
- More stores out by Marquette Park and British Landing
- Less expensive bike costs
- More toy stores
- More trees
- For tourists, not litter

High School Answers:

- Road conditions, they tend to be in bad shape and it doesn't seem like they have been doing much lately to improve this
- Road conditions and enforcement regarding pedestrians staying on the sidewalk
- The horse drivers need to stay on their side of the road. I have seen way too many accidents just because they were clogging up the road.
- Less hotels such as minor hotels and more buildings with events to make the island more fun.
- Get rid of Starbucks and prevent anything but local businesses, no corporations should be allowed, it ruins the island's originality.
- Airport improvements. UMCD is already state run, but having more people fly into the island will make a lot of money with landing fees.
- The attitude of some of the people on the island.
- To limit the visitors on bikes in the downtown areas, especially on Main Street. Most visitors have never ridden bikes before, so they crash and create more hazards for other riders.

- Install a better traffic system as it is currently chaos trying to get through town in peak tourist season between buggies and bikers going every which way not sticking to one side of the road and tourists walking in the middle of the road. There are times where you can't use the road it is so blocked up.
- Island police should be stricter on jaywalking and tourists paying little attention to the road. It's legal to give someone a ticket for jaywalking, so I don't know why we don't do that. Some people get seriously injured and its usually due to the fact that they weren't paying attention to their surroundings.
- No vacant business. I would like to see that because the city could be up and running more. You might have more people walking by that place and buying things. Tourists will not be sad to see that not empty anymore. They would probably go in it and not be afraid to walk by it.
- Nothing
- Turtle Park. Over the summer as soon as I get off work I go to the park and play basketball. The court is pathetic. The rims have no give, the nets are broken, there is no box on the backboard, and the lines painted on the court are wavy and tacky.

Question 7: Is there anything else you would like to share about the future of Mackinac Island?

4th, 5th, & 6th Grade Answers:

- Nope
- More stuff for island
- Not really
- Do not let Starbucks do business
- Nothing
- The rest is good
- No
- Nope
- No

Middle School Answers:

- Mackinac Island will be awesome!

- No
- No
- No that's it
- No
- Have a place to buy local fish so people don't have to go off the island to get fresh and local fish
- In the future there will be no trash anywhere in the forest and side walks
- Make fast food restaurants, movie theaters, beach, roller coaster, zip lines, bounce houses, Chucky Cheese, toy stores
- Keep forests clean
- Water park
- Nothing else
- Remain historical
- That there will be a waterpark
- That trees are still here and Mackinac's beauty is here for generations to come.
- No there is not
- No
- Remain historical
- Keep island historical
- You can take pictures

High School Answers:

- No, not that I can think of.
- Maintaining the integrity of the island's history is important, but appealing to a larger audience is something to keep in mind when the Island's future is in question.
- It is a great place for both tourists and residential citizens. The most important thing to maintain is just to keep it the way it should be. Areas like the Village, Stonecliffs, and the downtown area should stay the same. However, Mission Point is overrun and needs some serious work.
- The island seems to be coming more modern and hotels instead of keeping original and unique.
- The island needs to stay local and original, corporations would ruin what makes the island what it is.

- Stop allowing the city from going out of their way to stop companies from doing something so insignificant it embarrasses the city by trying to stop it.
- The taxis and drays don't work well with each other and they are always arguing and blocking the road. This makes it dangerous for visitors riding bikes, when they have never ridden bikes before.
- I hope it stays generally the same to preserve its historic value. There are changes that need to happen in order to improve the island, but I hope the historic value of the island is untouched.
- The future is bright, but the city has to maintain an historic feel and yet progress to meet every day demands.
- I would like to see more housing for people who work on the island all year around. It is really hard to get people to work on the island if they do not have anywhere to stay. (That does not mean construction work)
- It will be great.
- Starbucks almost has a monopoly over Lucky Bean and it makes me upset that a family business is suffering from a corporate business.

Appendix F

Community Workshop Results

Mackinac Island Master Plan Update

Results from September 21, 2016 Workshop

Aspirational Needs / Problems to be Solved Exercise:

Group 1 Response:

1. Congestion/Traffic flow, i.e. too many bike licenses, carriages too big, - traffic flow of tourists
2. Housing/affordable & employee/ zoning
3. Preserve green space/ air space
4. Integrity of year round community
5. Traffic laws, i.e. speeds for bikes, cars, scooters
6. Infrastructure
7. Trash/compost/recycle programs
8. Water/ [spelling]

Group 2 Response:

1. Affordable housing for year round young families
2. Preventing a tunnel effect on Main Street by encouraging various building heights and open spaces
3. Be mindful of how the city looks to people arriving in the harbor
4. Congestion on Main Street with benches State Park visitors; create a boardwalk from the Chippewa Center to Windermere point on waterfront
5. Enable us to remain a vibrant, viable year round community (attracting key people to service the community, ex: Dr, teachers, lineman) Note: table downtown mobility
6. Challenges to maintaining our historic ambiance, step back in time, such as electric bikes
7. When there are large # of winter visitor, overwhelming our limited Island winter resources by large numbers of winter visitors
8. Winter transportation

Group 3 Response:

1. Lighting & safety concerns
2. Apartment-style housing
3. History (post 1900's?)
4. Congestion at ferry docks!
5. Motorized vehicles (speed!)

6. Electric carts (license? Alternatives?)
7. Attracting & keeping professionals (lineman, teachers etc.)

Group 4 (DATA DRIVERS) Response:

1. Congestion, bike – human, carriages, freight – lack of data harvesting
2. Affordable housing, employee housing; How to keep Harrisonville a viable neighborhood; rental housing
3. Demographics of island needs to be assessed and evaluated
4. Health & safety/ Maintain medical center/ Sewer & infrastructure capacity
5. City Master Plan be in collaboration with State Park Strategic Plan
6. Historic designation needs to be maintained, state & local districts
7. Preserve environmental integrity of island – keep invasive species out

Group 5 Response:

1. Waterfront access visibility, pedestrian access & enjoyment of lake and relief of crowding on main street
2. Affordable housing for young family (year-round)
3. Better access to Lake for small boats (kayakes, small boater boats)
4. Water quality management – Runoff/ Algae?
5. Downtown traffic – Public safety; Overcrowding – Downtown traffic
6. Nighttime recreation for families – Events – better outreach & info; summer tourist family night time recreation
7. State park: collaboration
8. Transparency – public participation; transparency with city government, digital?
9. Employee & rental housing
10. Hospitable to private horses and space

Group 6 Response:

1. Clean up the Harbor and Lakeshore and maintain historic harbor buildings
2. Not enough current information available on city website
3. Lack of affordable housing either to buy or rent
4. Lack of employee housing options and the cost of ferry transportation for employees
5. Maintain the ban on motorized vehicles
6. Remember that tourism is key to the economy
7. Maintain the safe environment that currently exists

Large Group Boards:

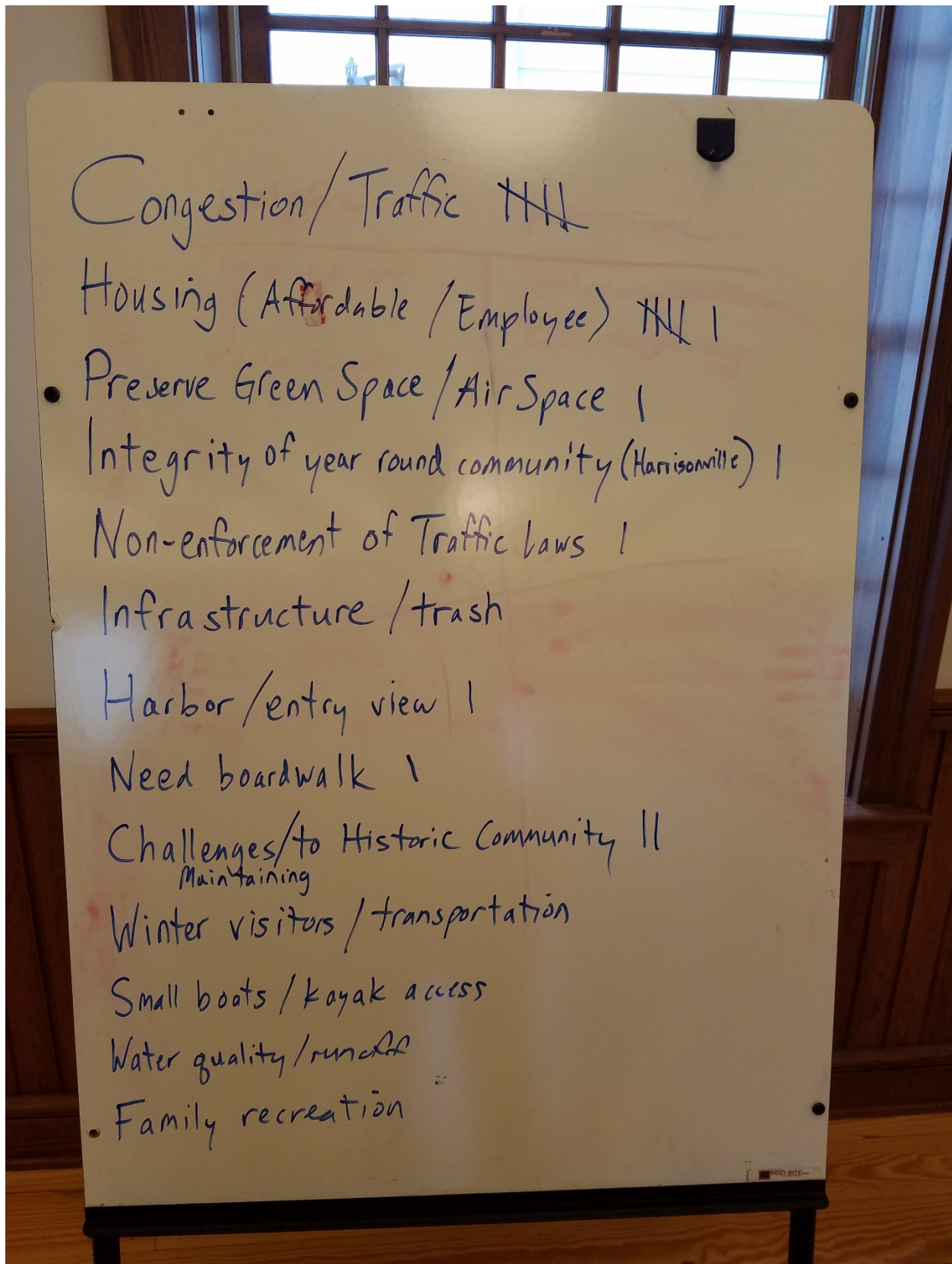

City govt. transparency 1

Maintaining horse culture

Maintaining ban on motor vehicles

Integrity of tourist economy

Maintaining safe/healthy community/lighting II

Alternatives to electric vehicles

Attracting/keeping service community/employees/professionals

Lack of data/harvesting (how many visitors?)

Evaluate community demographics

Collaborate w/ State Park in Master Plan and their Strategic Plan

Environmental integrity/invasive species

Goals and Policies Exercise:

Planning and Community Development Goals and Policies

Group 1 Response:

- Related to “Foster community cooperation to meet the needs of residents and tourists while preserving the natural environment and unique historic character of Mackinac Island and to preserve the National Historic Landmark designation.”: Agree
- Related to “Promote an open Island decision-making process and encourage on-going active citizen involvement.”: Agree
- Related to “Protect and preserve Island history, including historic sites, neighborhoods, buildings, structures, and scenic features.” Agree: Working: Yes
- Related to “Encourage creative historic design and planning techniques which produce visual harmony while preserving the significant natural and historic features of Mackinac Island.”: Agree; Working: Not Sure
- Related to “Review the Zoning Ordinance upon adoption of the Master Plan and amend as appropriate.”: Agree
- Related to “Work with State Park, conservation agencies, and private groups to preserve historically significant structures and buildings.”: Agree; Working: Yes

Group 2 Response:

- Related to “Communicate the importance of the tourist industry to the local economy”: Crossed Out
- Related to “Review the Zoning Ordinance upon adoption of the Master Plan and amend as appropriate”: requirement
- Related to “Develop or utilize innovative planning and zoning techniques, to allow for mixed land uses and increased employee housing and/or apartments in the downtown. Review employee housing density issues in the Zoning Ordinance.”: ‘Review employee housing density issues in the Zoning Ordinance’ – Underlined, More
- Related to “Encourage planned land uses in coordination with public utility, facility, and service improvement programs”: We do
- We have created three historic districts to meet some of these goals
- More frequent interactions between the city and the State Park in regards to common issues – State Park understand the long term implications to the city
- Health and welfare of city dependent on a tax base – it is hurt each time the State acquires a property and takes it off the tax base

Group 3 Response:

- Related to “Communicate the importance of the tourist industry to the local economy”: ✓ #

Group 4 (DATA DRIVERS) Response:

- Not to lose complacency on Historic Designation
- Related to “Promote an open Island decision-making process and encourage on-going active citizen involvement”: DREAM ON
- Related to “Encourage creative historic design and planning techniques which produce visual harmony while preserving the significant natural and historic features on Mackinac Island”: City Architect needs to adhere to historic principles
- Related to “Utilize a proactive planning process as a check and balance on decision making. Review and update this Master Plan, if necessary, as required by Michigan Planning Enabling Act.”: Please Do this
- Related to “Develop or utilize innovative planning and zoning techniques, to allow for mixed land uses and increased employee housing and/or apartments in the downtown. Review employee housing density issues in the Zoning Ordinance.”: Enough Downtown, Commuter Employee System, Utilize St. Ignace
- All Goals & Policies of the entire document needs to be properly executed with proper demographic data – USE IT!! FOR DECISION MAKING

Group 5 Response:

- During Census’s, have a city liaison for those taking the census to help them find everyone and ensure the success of data collection.
- Update city presentation of data and city meetings. Meetings on Youtube, packets available on website.
- Engage in city data collection of specific # collection, i.e. # of tourists, bikes,
- Create way to contribute anonymous city concerns, issues, zoning or violations to the city/public, without blowback to individuals.
- Explore and create specific regulations for scooter/ebike rentals.

Group 6 Response:

- Clean up the Harbor and Lakeshore and maintain and restore harbor scape.
- The Downtown Historic Harbor Shoreline is on the verge of losing MOST of its historic character – a plan that is aggressive and forward thinking must be devised to maintain its historic character of the beach or re-build the Beach and create a boardwalk which is a major undertaking and requires a major plan to accomplish.

- Establish a Downtown Historic Harbor Committee to work upon the development of a Boardwalk and a restoration of a shoreline, or preservation of the most significant feature of the historic harbor – its historic natural shoreline.

Goals and Policies Exercise:

Housing Goals and Policies

Group 1 Response:

- Related to “Encourage the development of housing to meet the needs of all household types and income groups, including affordable single-family housing and housing options for the elderly.”: Agree with Policy; Needs more work
- Related to “Protect the neighborhood feeling of residential areas”: Agree with Policy; Zoning needs work.
- Related to “Encourage the maintenance of the existing housing stock and residential neighborhoods in good repair, appearance, usefulness, and safety.”: Agree with Policy; Zoning needs work.
- Related to “Identify appropriate development standards, regulations, and locations for employee housing”: Agree with Policy; Consider requiring new hotels to provide on-site housing for employees.
- Related to “Match allowable residential densities to the characteristics and available services of proposed sites, considering infrastructure needs such as roads, public water, utilities, and especially the capacity of the Island’s public wastewater system.”: Agree with Policy; Needs Work REV’s
- Related to: “Acknowledge and maintain our Island’s unique summer cottage community.”: Agree with Policy; Needs work.

Group 2 Response:

- Related to “Protect the neighborhood feeling of residential areas”: ‘neighborhood feeling’ crossed out
- [All listed Housing Policies noted as “Commendable”]
- Develop some housing for some income groups
- City pays for the financial planning for prospective homeowners
- Find land outside the roles of MSHDA[spelling] to build

Group 3 Response:

- No Comments

Group 4 (DATA DRIVERS) Response:

- Related to “Protect the neighborhood feeling of residential areas”: [Starred]
- Related to “Encourage the maintenance of the existing housing stock and residential neighborhoods in good repair, appearance, usefulness, and safety.”: Use enforcement; neglected!
- Related to “Identify appropriate development standards, regulations, and locations for employee housing”: ‘locations’[circled]; No process – we need one – Encourage St. Ignace
- What is the domino effect of affordable employee & rental – how does it effect the positively or negatively housing and Historic needs –
- New Employee housing puts a strain on sewer system

Group 5 Response:

- Implement ordinances that enforce original planning proposals as presented to planning committees (If I say it will be housing, IT MUST BE HOUSING)
- Initiate and evaluate a city sponsored sewer project/infrastructure in Harrisonville to improve water quality and failing septic (via grants)
- Work with businesses to identify and plan strategy for all businesses to adequately house employees.
- Plan and oversee creation of year round resident rentals of quality housing for low income residents.

Group 6 Response:

- Rental – year-round
- Encourage City to work with developer – to create and build rental housing for year-round community
- Related to “Protect the neighborhood feeling of residential areas”: Needs more work.
- As the development pressures work against the #1 problem which is affordable housing/[spelling] the traditional people and culture to remain, that bigger and more aggressive and outside of the box thinking must come in to play.

Goals and Policies Exercise:

Natural Environment, Public Lands and Recreation Goals and Policies

Group 1 Response:

- Related to “Preserve the unique beauty of Mackinac Island by protecting natural areas and landmarks, waterfront setting, and historic structures.”: Agree; Needs more work ongoing
- Related to “Identify, acquire, and protect desirable open space areas, scenic vistas, and environmentally sensitive lands.”: Agree; How much can City do?
- Related to “Partner with State Park, conservation agencies, and private groups to preserve natural areas.”: Agree; Needs work.
- Related to “Encourage a land use pattern that is oriented to and respects the natural features and water resources of the area. Promote the protection of sensitive features including shoreline, wildlife habitat, wildlife corridors, wetlands, water quality, steep slopes, native plants, dark skies, and wooded areas.”: Agree; Downtown needs help!
- Related to “Evaluate the environmental impact of all new development during the site plan review or special use permit process.”: Agree; Needs Work: Not Sure
- Related to “Preserve, maintain, and create active recreation areas, while continuing efforts to provide and expand recreational opportunities for all ages.”: Agree; Needs Work: Not Sure
- Related to “Support cooperative recreational planning and development between the City, school, civic groups, and private entities.”: Agree; Needs Work
- Related to “Pursue outside funding sources, such as grants, for land acquisition and/or recreational development.”: Agree; Needs Work:?
- Related to “Maintain the Island’s adopted Recreation Plan and update at five-year intervals.”: Agree; Needs Work

Group 2 Response:

- Related to “Evaluate the environmental impact of all new development during the site plan review or special use permit process.”: Required

Group 3 Response:

- Related to “Encourage a land use pattern that is oriented to and respects the natural features and water resources of the area. Promote the protection of sensitive features including shoreline, wildlife habitat, wildlife corridors, wetlands, water quality, steep slopes, native plants, dark skies, and wooded area”: (runoff!)

Group 4 (DATA DRIVERS) Response:

- Related to “Encourage a land use pattern that is oriented to and respects the natural features and water resources of the area. Promote the protection of sensitive features including shoreline, wildlife habitat, wildlife corridors, wetlands, water quality, steep slopes, native plants, dark skies, and wooded areas.”: ‘wildlife habitat’, ‘wetlands, water quality, steep slopes’, ‘and wooded areas’ [Circled]
- Related to “Maintain the Island’s adopted Recreation Plan and update at five-year intervals.”: Promote in community
- Collaborate with State Park Strategic Plan
- Discourage use of invasive species
- Encourage removal of invasive species where appropriate

Group 5 Response:

- Create/explore beach access/boardwalk/pier to give more pedestrian access to water view downtown.
- Expand small boat/kayak program, make putting in access to water and more racks.
- Evaluate runoff from different area, waste into the golf course/drainage and waste runoff at arch rock. Investigate algae bloom and information.
- Create a plan/proper infrastructure to address it.

Group 6 Response:

- Related to “Preserve the unique beauty of Mackinac Island by protecting natural areas and landmarks, waterfront setting, and historic structures”: Harbor Scape

Goals and Policies Exercise:

Infrastructure, Public Services and Traffic Goals and Policies

Group 1 Response:

- Related to “Preserve and strengthen the ban on “horseless carriages” and promote the use of horses for recreation and transportation.”: Agree with Policy; Enforced: Electric Bikes
- Related to “Encourage the efficient use and maintenance of existing roadways and infrastructure.”: Agree with Policy; Not really enforced
- Related to “Evaluate options for relieving traffic congestion during peak times.”: Agree with Policy; Enforced?
- Related to “Provide improved visitor orientation and education.”: Agree with Policy; Not enforced

- Related to “Seek ways to reduce conflicts between different modes of transportation, i.e. horses, bikes, and pedestrians and continue policies to accommodate persons with disabilities.”: Agree with Policy; Not enforced
- Related to “Provide additional public restrooms, bike parking areas, public seating, trash receptacles, and drinking fountains in the downtown area.”: Agree with Policy; Not enforced
- Related to “Encourage the coordination of services, such as deliveries and trash removal, to occur during off-peak times to reduce congestion.”: Agree with Policy; Pretty much enforced
- Related to “Maintain dedication to the advanced recycling and composting programs, water filtration, and wastewater treatment.”: Agree with Policy; Need more compliance
- Related to “Continue public education programs regarding existing programs and facilities.”: Agree with Policy; More enforcement
- Related to “New development should be compatible with the capacity limitations of the water and wastewater treatment facilities and roads until these facilities are expanded.”: Agree with Policy(yes!); partially enforced?
- Consider a limit on bike rental licenses
- Consider limit on number of carriages permitted on street at one time

Group 2 Response:

- Related to “Evaluate options for relieving traffic congestion during peak times.”: ‘Evaluate’ Crossed out, replaced with ‘Implement’
- Related to “Provide improved visitor orientation and education.”: Strengthened & Signage
- Related to “Encourage the coordination of services, such as deliveries and trash removal, to occur during off-peak times to reduce congestion.”: ‘Encourage’ Crossed out, replaced with ‘better’
- Continue -

Group 3 Response:

- Related to “Provide additional public restrooms, bike parking areas, public seating, trash receptacles, and drinking fountains in the downtown area”: ‘public restrooms’ – underlined; ‘drinking fountains’ – underlined, water bottle refilling?
- Attracting & Keeping professionals (lineman, doctors, nurses, teachers, etc.)

Group 4 (DATA DRIVERS) Response:

- Harvest sufficient data to execute policies below – otherwise its emotion. FACTS MATTER!

- Related to “Encourage the efficient use and maintenance of existing roadways and infrastructure.”: Limit commercial traffic in Residential neighborhood
- Related to “Evaluate options for relieving traffic congestion during peak times.”: *Get Data
- Related to “Provide improved visitor orientation and education.”: *Get Data
- Related to “Seek ways to reduce conflicts between different modes of transportation, i.e. horses, bikes, and pedestrians and continue policies to accommodate persons with disabilities.”: Parking/Limit Bikes
- Related to “Encourage the coordination of services, such as deliveries and trash removal, to occur during off-peak times to reduce congestion.”: Increase trash removal
- Related to “Continue public education programs regarding existing programs and facilities.”: * Keep Channel “3”
- Related to “Recruit, train, and provide continuing support for Island volunteers who provide emergency services”: Vital!
- Related to “New development should be compatible with the capacity limitations of the water and wastewater treatment facilities and roads until these facilities are expanded.”: GET DATA!!

Group 5 Response:

- No Comments

Group 6 Response:

- Related to “Improve and maintain the transportation systems, community facilities, programs, and public utilities to accommodate the needs of residents and visitors”: + Safety
- Related to “Evaluate options for relieving traffic congestion during peak times”: +work has been done, more can be done
- Related to “Provide additional public restrooms, bike parking areas, public seating, trash receptacles, and drinking fountains in the downtown area”: bike parking areas – done; public seating – done; trash receptacles – could have more
- City website should better utilized and current to provide draft minutes and then approved minutes of public meetings – Council/PC/HDC.
- Teach Hospitality to Safety Officers